



- Three Storey Town House
- Three Bedrooms
- Kitchen/Diner
- Well Presented Throughout
- Immaculately Presented
- Landscaped Garden with Summerhouse
- Garage & Parking
- Popular Village Location

Ruddle Way, Langham LE15 7NZ

Offers Over £285,000

An immaculately presented three storey home, enjoying an open aspect to the rear. The property has been kept to a high standard throughout, offering accommodation comprising an entrance hallway with integral access into the garage, downstairs shower room and utility room and ground floor bedroom/garden room with double doors to outside. Stairs to the first floor lead to a spacious sitting room with dual windows and the open plan dining kitchen. Stairs to the second floor lead to two double bedrooms, the master with ensuite shower room and family bathroom.

Externally, the property offers a paved driveway to the front providing off road parking for two vehicles and integral single garage. The rear garden has been beautifully landscaped to provide a decking area with canopy over, pond and summerhouse with electric to sit out and enjoy the garden.





For more information contact one of our team. Outside office hours via outofhours@moorestateagents.com 7 days a week until 9pm.

Ground Floor

Approx. 36.9 sq. metres (397.3 sq. feet)

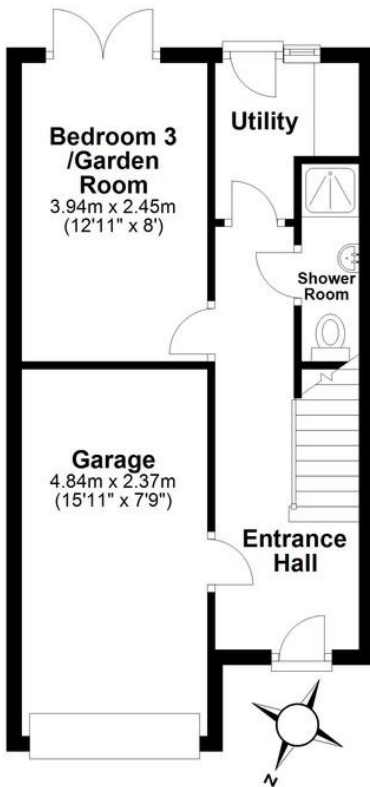

First Floor

Approx. 39.4 sq. metres (424.4 sq. feet)

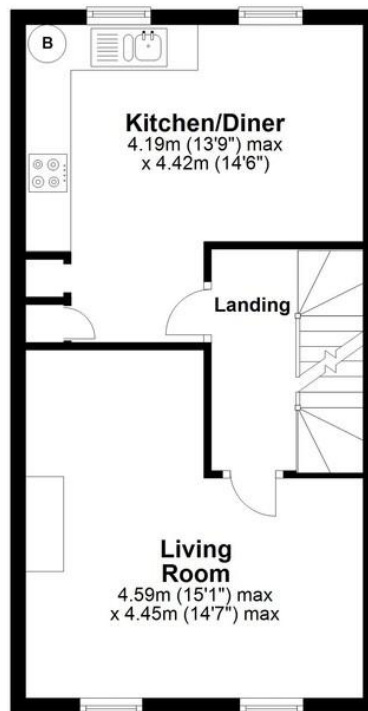

Second Floor

Approx. 39.7 sq. metres (427.4 sq. feet)

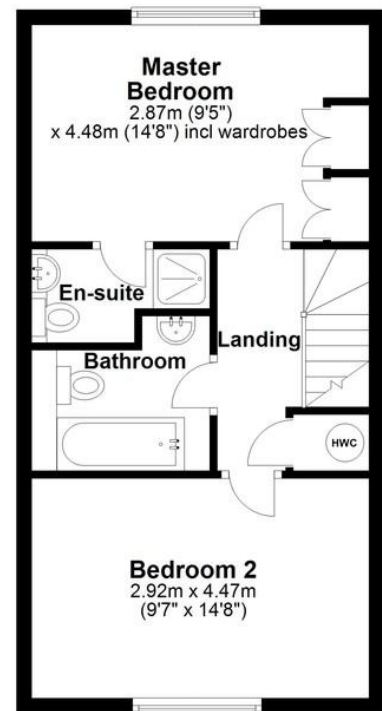

Total area: approx. 116.0 sq. metres (1249.1 sq. feet)

This floor plan is not to scale. They are for guidance only and accuracy is not guaranteed. Plan was produced by ADR Energy Assessors
Plan produced using PlanUp.

Moore V Ltd trading as Moores Estate Agents gives notice that: 1. These particulars do not constitute an offer or contract or part thereof. 2. All descriptions, photographs and plans are for guidance only and should not be relied upon as statements or representations of fact. All measurements are approximate and not necessarily to scale. Any prospective purchaser must satisfy themselves of the correctness of the information within the particulars by inspection or otherwise. 3. Moore V Ltd trading as Moores Estate Agents does not have any authority to give any representations or warranties whatsoever in relation to this property (including but not limited to planning/building regulations), nor can it enter into any contract on behalf of the Vendor. 4. Moore V Ltd trading as Moores Estate Agents does not accept responsibility for any expenses incurred by prospective purchasers in inspecting properties which have been sold, let or withdrawn. 5. If there is anything of particular importance to you, please contact this office and we will try to have the information checked for you.

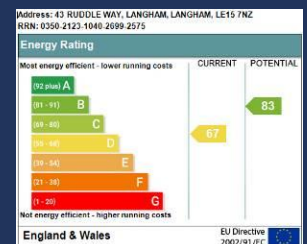

25 Burton Street,
Melton Mowbray
01664 491610

36 High Street,
Oakham
01572 757979

2 Orange Street,
Uppingham
01572 821935

1 Sheep Market,
Stamford
01780 484555

London Platform,
Peterborough Station
01733 788888

London Platform,
Grantham Station
01476 855618

Follow us on... Facebook Twitter

www.mooresestateagents.com | office@mooresestateagents.com