



1,117
sq ft



REDBRIK
ESTATE AGENTS



Helping you find
your home at...

Mansfield Road, Hasland
Guide Price £140,000 to £145,000

Recently renovated back to brick to a very high standard throughout, this three bedroom end terrace house is situated within the sought after village of Hasland.

- Three Bedroom End Terrace House
- No Onward Chain
- Modern Fitted Kitchen/Dining Room With Integrated Appliances
- Spacious Living Room
- Garden Room Which Leads To The Rear Patio Area
- Three Good Sized Double Bedrooms
- Bathroom With Three Piece Suite
- Low Maintenance Rear Garden
- On Road Parking
- Energy Rating - D, Tenure; Freehold.





£140,000 to £145,000 (Guide Price)

Buying for myself, or with my partner...

- A perfect opportunity for someone looking to get onto the property ladder.
- Situated in an excellent location for all the local shops and amenities that Hasland has to offer.
- Suiting professionals travelling for work, you have ease of access to the motorway.
- The property boasts flexible living and dining space, meaning you could utilise room to suit your specific needs.

This is for my family...

- Offering ample living and dining space with plenty of storage.
- The three bedrooms are all excellent sizes alongside a modern fitted bathroom.
- Having been fully renovated from top to bottom, the property is neutrally decorated and ready to move straight into.
- An enclosed & low maintenance garden offers a secure space for children to play whilst adults can relax in the spacious garden room.
- the cellar/lower ground floor store has the potential to create more living space or a home office space (subject to necessary consents).

I'm looking for investment...

- We believe the property would rent for approximately £575 per month, a yield of 4.93%.
- Ideal for a first-time landlord, the property has been fully renovated, meaning your tenant can move straight in.
- Prospective tenants would love the living & dining space, well-proportioned bedrooms and location. Tenure: Freehold



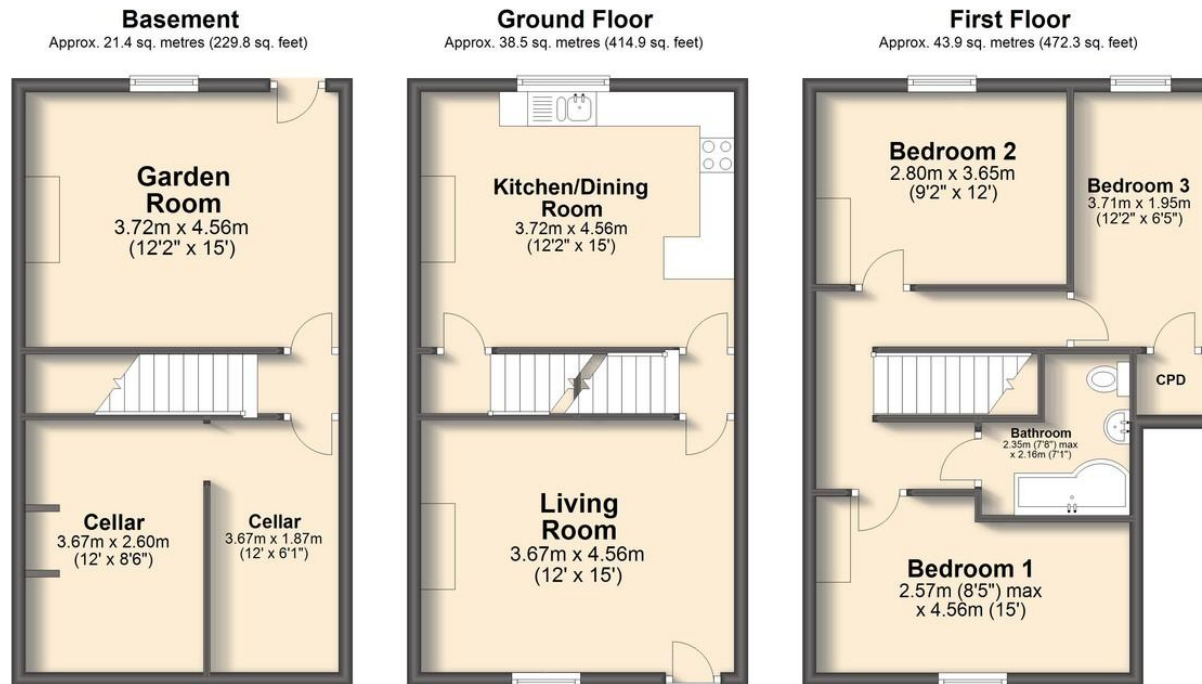

Total area: approx. 103.8 sq. metres (1117.0 sq. feet)

We endeavour to make these particulars as accurate as possible, but they should only be used as guidance and they do not constitute any part of the contract. All measurements are approximate and no guarantees are made to the services, heating systems, appliances (if any) or fittings as to their working order and no warranty can be given or implied.

You may download, store and use this material for your own personal use and research. You may not republish, retransmit, redistribute or otherwise make the material available to any party or make the same available on any website, on or offline service or hard copy without the website owner's express written consent. The website owner's copy right must remain on all reproductions of material taken from this website.