

24 Market Place, Bolsover, Chesterfield, S44 6PN
01246 822 138
enquiries@wilsonstateagents.co.uk
www.wilsonstateagents.co.uk



240 Victoria Street
Chesterfield, Derbyshire S44 6LG

OFFERS IN THE REGION OF £89,950

NO CHAIN In need of refurbishment and modernisation, with the potential to add value, this ideal investment opportunity would suit first time buyers and landlords alike, the accommodation is deceptively spacious comprising two reception rooms, kitchen, three bedrooms and bathroom. There is an enclosed, low maintenance yard to the rear. The property is ideally placed for accessing the M1 via J29a Markham Vale and the nearby towns of Chesterfield and Mansfield.

240 VICTORIA STREET, CHESTERFIELD, DERBYSHIRE S44 6LG



Ground Floor

Approx. 39.0 sq. metres (420.2 sq. feet)

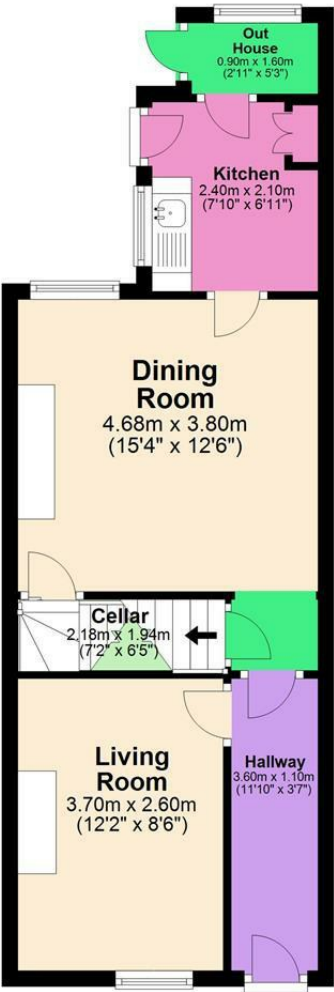

First Floor

Approx. 31.9 sq. metres (343.6 sq. feet)



Second Floor

Approx. 22.4 sq. metres (241.3 sq. feet)



Total area: approx. 93.4 sq. metres (1005.1 sq. feet)

