

GROUND FLOOR
558 sq.ft. (51.9 sq.m.) approx.

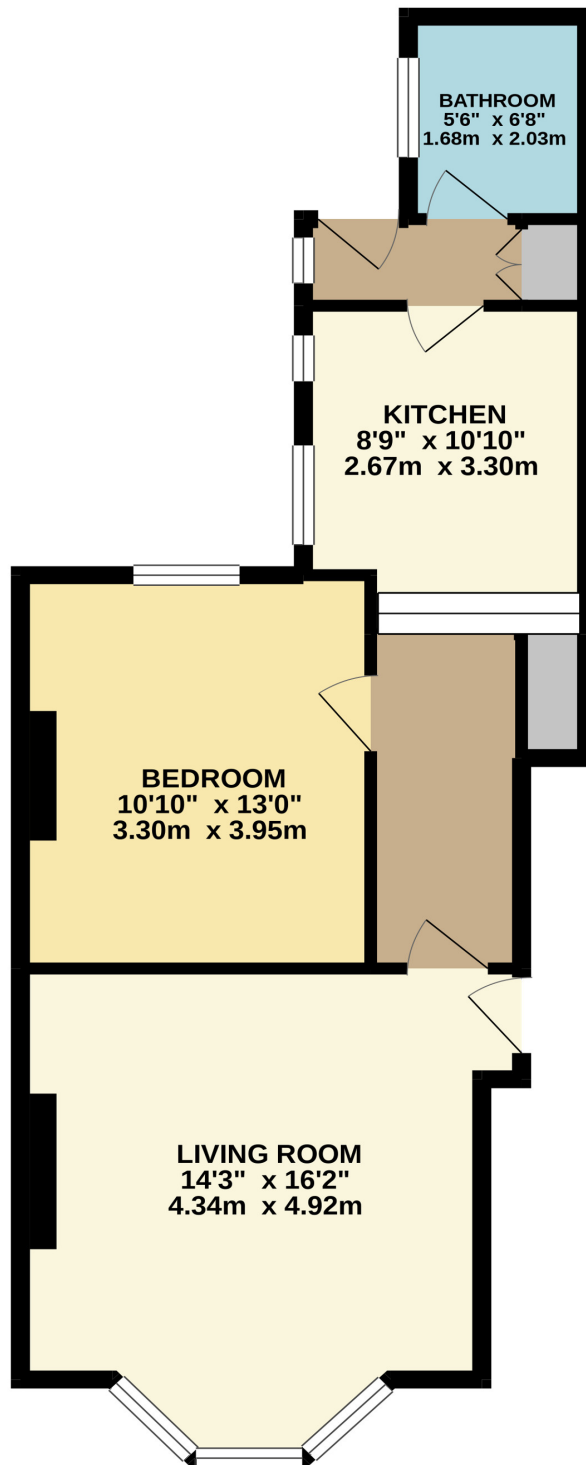

TOTAL FLOOR AREA : 558 sq.ft. (51.9 sq.m.) approx.

Whilst every attempt has been made to ensure the accuracy of the floorplan contained here, measurements of doors, windows, rooms and any other items are approximate and no responsibility is taken for any error, omission or mis-statement. This plan is for illustrative purposes only and should be used as such by any prospective purchaser. The services, systems and appliances shown have not been tested and no guarantee as to their operability or efficiency can be given.

Made with Metropix ©2021

9 Albert Street, Harrogate
North Yorkshire HG1 1JX
Sales: 01423 503076
Lettings: 01423 530744

These particulars are given as guidance only and are expressly excluded from any contract. They give no warranty as to the condition or description and any recipient must satisfy himself on all matters stated herein. The property is offered subject to contract and to its being unsold and unlet. Appointments for viewing and contract of all negotiations shall be through Nicholls Tyreman Estate Agent.



**FLAT 1, 81 FRANKLIN ROAD
HARROGATE, HG1 5EH
£675 PCM**

UNFURNISHED

A well-presented one-bedroom, ground-floor flat, within easy reach of the town centre and excellent amenities.

The accommodation benefits from gas central heating and comprises: Communal entrance hall with entry system, living room with bay window and fireplace, fitted kitchen with under-stair storage, one double-bedroom and house bathroom with panelled bath having shower over and glazed side screen, wash hand basin and low flush wc.

1 Bedroom

1 Reception Room

1 Bathroom

Available Now

£778.85 Returnable Bond

No Smokers/Pets

Council Tax: A - £1,338.12

Energy Rating - C

DIRECTIONS - HG1 5EH

From Harrogate take Parliament Street and at the traffic lights turn right onto Kings Road. Turn right onto Strawberry Dale Avenue and then turn left onto Franklin Road.





APPROXIMATE DISTANCES

Town Centre	650 metres
Railway Station	650 metres
Bus Route	250 metres
Airport	12.8 miles