



30 Honeysuckle Close | Ross-On-Wye | Herefordshire | HR9 7RJ

£495



nicholas
terry
sales & lettings

A recently re-decorated one bedroom first floor flat benefitting from gas central heating and allocated off-road parking. *** Available Now ***

Ground Floor

Communal Hallway

First Floor

Lounge	15'4" x 8'1" (4.69m x 2.48m)
Kitchen	8'5" x 5'8" (2.59m x 1.73)
Bedroom	10'7" x 7'10" (3.23m x 2.40)
Bathroom	6'6" x 5'8" (2.00m x 1.73m)

EPC RATING - C

Ground Floor

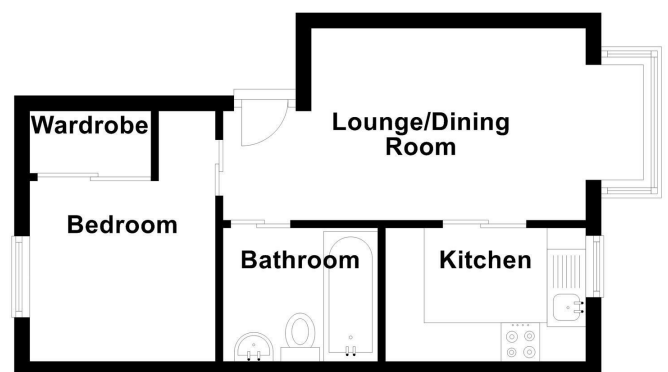

From the centre of Ross on Wye proceed down Broad Street, fork left into Brampton Street, take the second turning left into River View, proceed into Vaga Crescent taking the third left into Honeysuckle Close and follow the road around to the right where the property can be found on the left hand side.