

For Rent



People Make Places



Little Newport Street, Chinatown WC2H

2 bedrooms | 732 sq ft

£795 pw





A beautifully presented two bedroom apartment located in the heart of the West End, this new development is only a short walk from Leicester Square and Piccadilly Circus. The apartment has high ceilings throughout, a large semi open plan kitchen and two spacious double bedrooms with ample built in storage.

What you need to know

- Two bedrooms
- Two shower rooms (one en-suite)
- Third floor
- Wooden flooring throughout
- Open plan kitchen/reception room
- Unfurnished
- Built in storage in both bedrooms
- Moments from Leicester Square station
- Recently refurbished
- Available early March





Overview

The property is available immediately on an unfurnished basis. The landlord offers a 3 year term with a mutual rolling break clause at 6 months. Westminster Council tax band: F.

WHAT WE LOVE Recent refurbishment

Heart of the West End

High end kitchen and bathrooms

Moments from PF Changs

Beautiful built in storage

WHAT YOU NEED TO KNOW Third floor (walk up)

Secondary glazing

Moments from Leicester Square station

Wooden floors throughout



Little Newport Street, Chinatown WC2H

People Make Places

London is collection of inspiring urban villages and one of the most exciting places in the world to live, work & play.

We work with both property owners and their occupiers, sharing the story of these vibrant neighbourhoods, conveying the unique soul & energy to future custodians, the people who'll keep them buzzing.

And unlike many real estate businesses we're not just about buildings, because streets & buildings don't make a neighbourhood.

We're about building relationships, because **people make places**.

MISINTERPRETATION ACT (COPYRIGHT) DISCLAIMER: Tavistock Bow Ltd for themselves and for the vendor(s) of this property whose agents they are, given notice that: 1. These particulars do not constitute, not constitute any part of, an offer or contract. 2. None of the statements contained in these particulars as to the property are to be relied on as statements or representations of fact. 3. Any intending purchaser or lessee must satisfy themselves by inspection or otherwise as to the correctness of each of the statements contained in these particulars. 4. The vendor(s) or lessor(s) do not make or give and neither Tavistock Bow Ltd nor any person in their employment has any authority to make or give any representation or warranty whatever in relation to this property. Finance Act 1989, Unless otherwise stated all prices and rents are quote exclusive of VAT. Property Misrepresentation Act 1991; These details are believed to be correct at the time of compilation but may be subject to subsequent amendment.

Follow us:     @tavistockbow

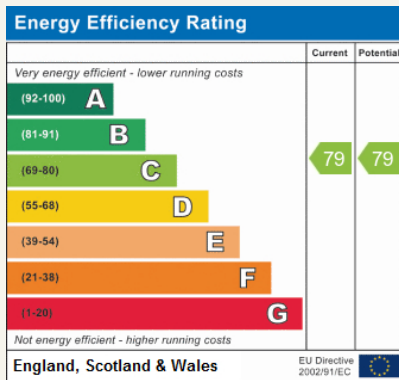

Little Newport Street, WC2

Approximate Gross Internal Area 68 sq m / 732 sq ft

Third Floor

- 1 Kitchen / Reception Room
5.38 x 3.97M
17'8" x 13'
- 2 Bedroom
4.12 x 3.96M
13'6" x 13'
- 3 Bedroom
4.22 x 3.62M
13'10" x 11'11"

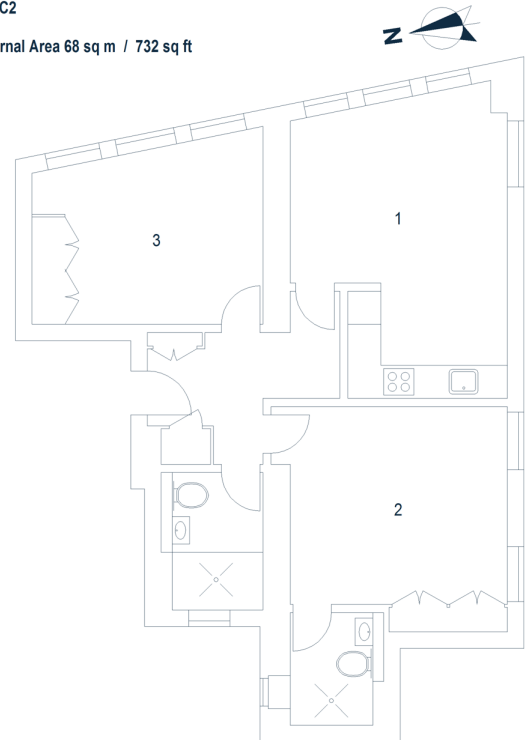

Floor Plan produced for Tavistock Bow by Mays Floorplans ©. Tel 020 3397 4594
Illustration for identification purposes only, not to scale.

tavistockbow

21 New Row, Covent Garden,
London, WC2N 4LE

t: 020 7477 2177
e: hello@tavistockbow.com
w: tavistockbow.com



Little Newport Street, Chinatown WC2H