



LOVE YOUR HOME

SALES // LETTINGS // PROPERTY MANAGEMENT



55 Legacy Tower, 88 Great Eastern Road, Stratford, London, E15 1DJ
£2,150 Per month



55 Legacy Tower, 88 Great Eastern Road, Stratford, London, E15 1DJ

£2,150 Per month

Modern, 26th floor, two bedroom two bathroom apartment in the heart of Stratford.

Amazing views all round and benefitting from the use of a 24hr concierge and residents only gym.

Two good sized bedrooms and two bathrooms, with an open plan living room/kitchen and a private balcony.

Offered part furnished and available now.

Description

Modern, 26th floor, two bedroom two bathroom apartment in the heart of Stratford.

Amazing views all round and benefitting from the use of a 24hr concierge and residents only gym.

Two good sized bedrooms and two bathrooms, with an open plan living room/kitchen and a private balcony.

Offered furnished and available now.

Situation

Walking distance to Stratford central/jubilee line and DLR station.

You can also take a high speed mainline train into Kent and beyond.

Westfield shopping center is located opposite the development.

Furnished

Council Tax Band:

Available:



Floor Plans

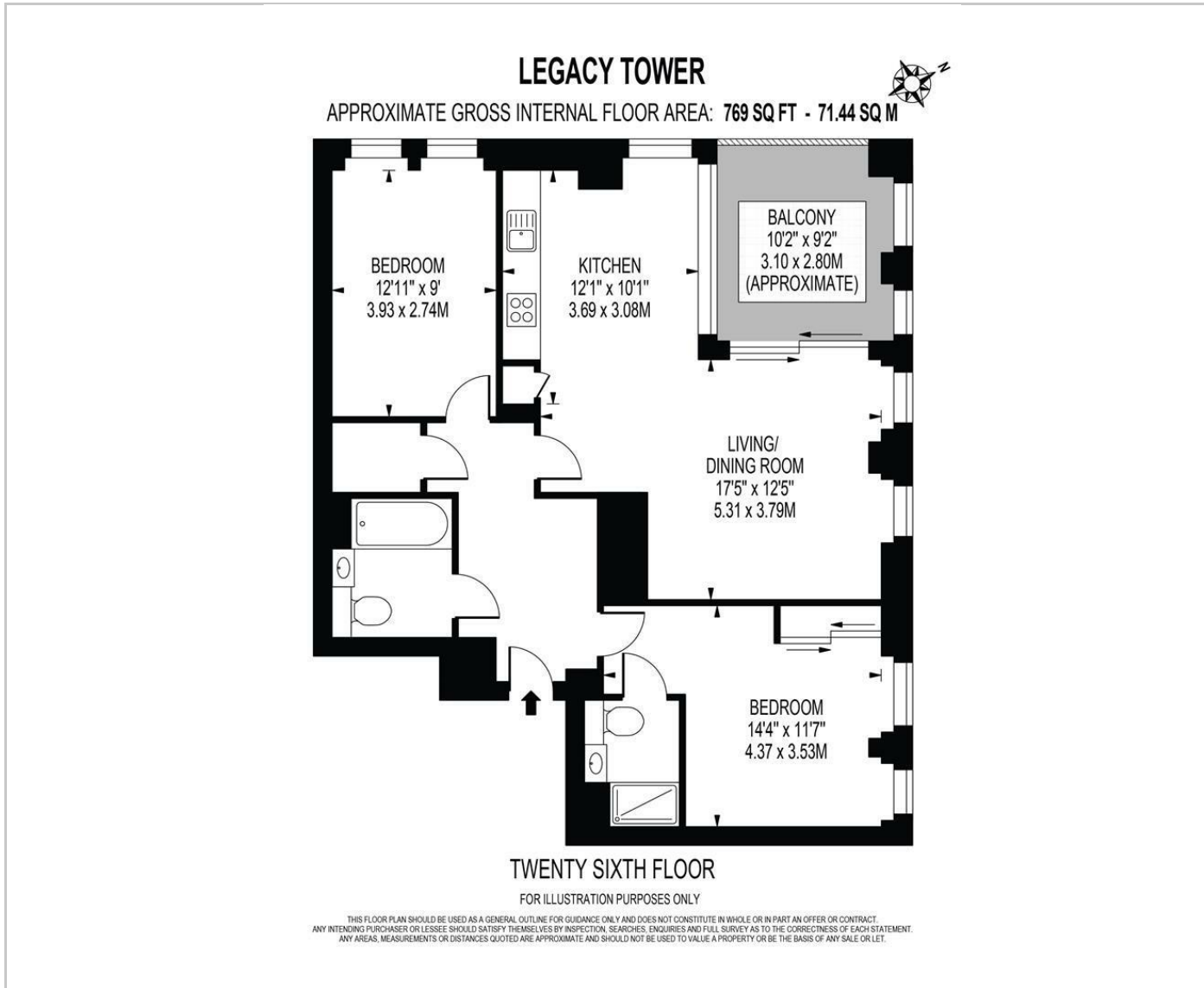

Area Map

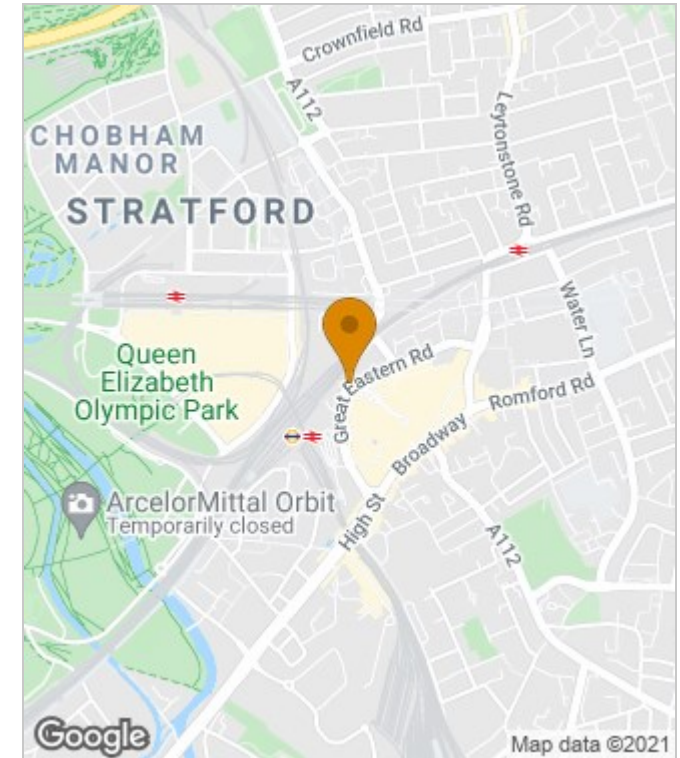

Energy Performance Graph

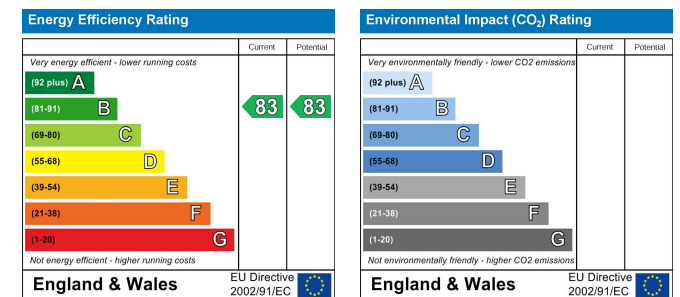

These particulars, whilst believed to be accurate are set out as a general outline only for guidance and do not constitute any part of an offer or contract. Intending purchasers should not rely on them as statements of representation of fact, but must satisfy themselves by inspection or otherwise as to their accuracy. No person in this firm's employment has the authority to make or give any representation or warranty in respect of the property.