



Flat 3 6 Brunswick Square, GL1 1UG

£595 PCM

np
naylor powell

Flat 3 6 Brunswick Square, GL1 1UG

• Split Level Apartment • Two Bedroom • Open Plan Living • City Centre Location • Gas Central Heating • EPC E39



Unit C Barge Arm East, Gloucester Docks, GL1 2DQ

01452 398010

docks@naylorpowell.com

www.naylorpowell.com

£595 PCM

Kitchen Area

5'4" x 7'8" (1.65 x 2.35)

Living Area

10'9" x 12'9" (3.30 x 3.90)

Bedroom One

10'7" x 10'11" (3.25 x 3.35)

Second Bedroom

5'4" x 9'0" (1.65 x 2.75)

Shower Room

4'5" x 7'2" (1.35 x 2.20)

Energy Performance Rating

Current: 30. Potential: 70.



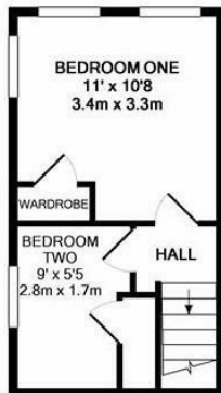

GROUND FLOOR

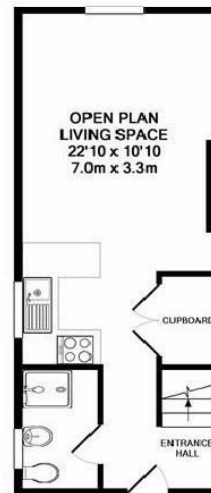

1ST FLOOR

Whilst every attempt has been made to ensure the accuracy of the floor plan contained here, measurement of doors, windows, rooms and any other items are approximate and no responsibility is taken for any error, omission, or mis-statement. This plan is for illustrative purposes only and should be used as such by any prospective purchaser. The services, systems and appliances shown have not been tested and no guarantee is given.

Disclaimer: These particulars do not form part of any contract and no responsibility is accepted for any errors or omissions in any statement made, whether verbally or written for or on behalf of Naylor Powell.

Floorplans have been prepared for identification purposes only, they are not to scale and no guarantee can be given as to their accuracy.

Prospective purchasers please be aware none of the appliances, boiler, heaters etc. which may have been mentioned in these particulars have been tested and no guarantee can be given that they are in working order. Prospective purchasers should arrange for such items to be tested at their own expense.

