



colin ellis

**Summerdale Apartments, Prince of Wales Terrace,
Scarborough, YO11 2AN**

A rare find on the South Cliff side of the town, a two bedroom self-contained ground floor apartment that has its own car parking space directly outside your own private door. The apartment has recently been refurbished and has been finished to a high standard. Would make an ideal holiday home or permanent residence.

Price Guide £149,950

 2	 1
 1	 TBC



A rare find on the South Cliff side of the town, a two bedroom self-contained ground floor apartment that has the benefit of its own car parking space directly outside your own private door. The apartment is in the process of being refurbished and will be finished to a high standard with new kitchen and bathroom suites, flooring and carpets. Would make an ideal holiday home or permanent residence.

LOCATION

When leaving Scarborough town on the A165 cross Valley Bridge Road and then turn left onto West Street. At the first junction with traffic lights turn right onto Prince of Wales Terrace and Summerdale Apartments are located on the left hand side.

ENTRANCE HALL

uPVC double glazed door opening to hallway with wood doors to all rooms.

LOUNGE

21' 3" x 16' 0" (6.5m x 4.9m)

uPVC double glazed windows, radiator



KITCHEN

12' 5" x 12' 4" (3.8m x 3.76m)

uPVC double glazed sash windows, radiator, gas combination boiler, full range of white base and wall units with coordinating worktop and integrated appliances.



BATHROOM / WC

7' 2" x 6' 10" (2.2m x 2.1m)

White suite with wash basin, WC and shower, tiled walls.



BEDROOM ONE

16' 4" x 9' 6" (5m x 2.9m)

uPVC double glazed sash window, radiator.

BEDROOM TWO

11' 5" x 6' 10" (3.5m x 2.1m)

uPVC double glazed sash window, radiator.

TENURE

Leasehold with maintenance agreement in place which is managed by a local agent. The current annual service charge is £1300 pax.



GROUND FLOOR 872 sq.ft. (81.0 sq.m.) approx.

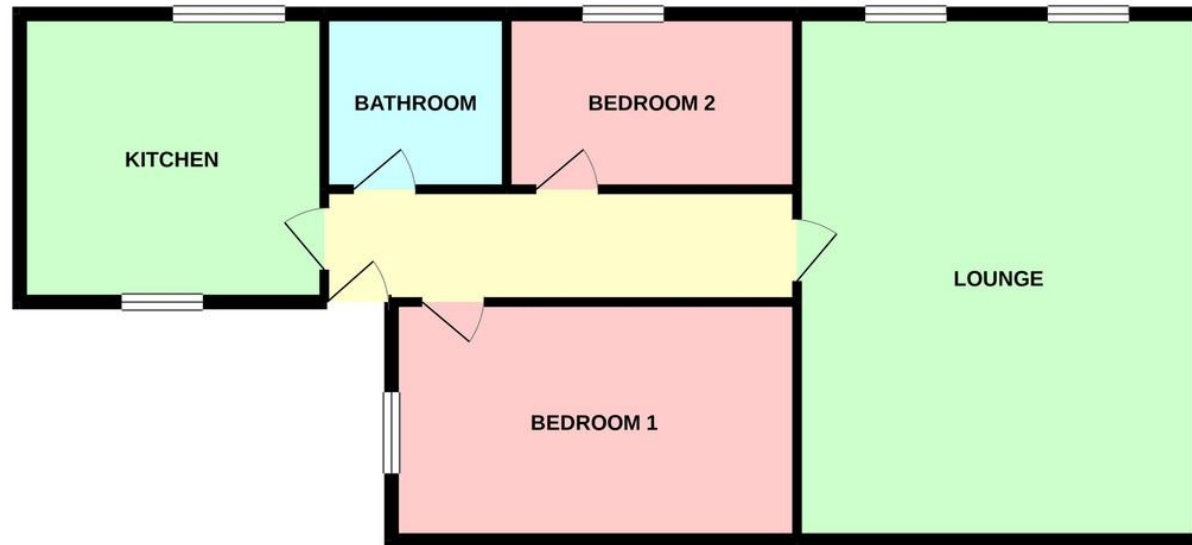

TOTAL FLOOR AREA: 872 sq.ft. (81.0 sq.m.) approx.

Whilst every attempt has been made to ensure the accuracy of the floorplan contained here, measurements of doors, windows, rooms and any other items are approximate and no responsibility is taken for any error, omission or mis-statement. This plan is for illustrative purposes only and should be used as such by any prospective purchaser. The services, systems and appliances shown have not been tested and no guarantee as to their operability or efficiency can be given.
Made with Metropix ©2021

Prince of Wales Terrace - Reference Number: 10908

DISCLAIMER: The agent has not tested any apparatus, fittings or services and so cannot verify they are in working order. The buyer is advised to obtain verification from their own solicitor or surveyor. Occasionally a wide angle lens may be used. This property was inspected by COLIN ELLIS PROPERTY SERVICES. We always try to make our sales particulars accurate and reliable, but if there is any point which is of particular importance to you, especially if you are considering travelling some distance to view the property, please do not hesitate to contact this office, we will be pleased to check the information for you. Council Tax Band ratings have been provided by DirectGov.



Tel: 01723 363565
E-mail: info@colinellis.co.uk

RESIDENTIAL & COMMERCIAL SALES
LETTINGS CHARTERED SURVEYOR

See all our properties online
www.colinellis.co.uk