

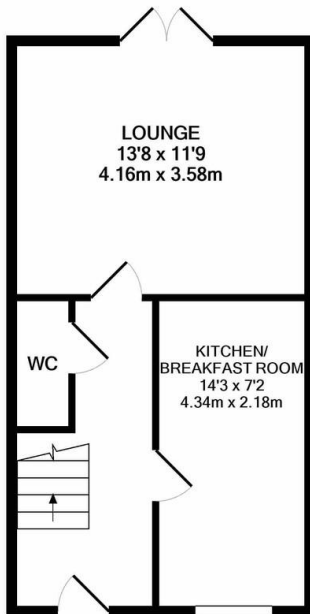

Property Summary

A well presented and well proportioned modern mid town house for sale close to the heart of Oadby town centre. The accommodation comprises entrance hall, downstairs w.c., breakfast kitchen, lounge, three good size bedrooms, family bathroom, rear garden and parking space. For more info or to view call Phillips George on 01162168178.



GROUND FLOOR
APPROX. FLOOR
AREA 356 SQ.FT.
(33.1 SQ.M.)

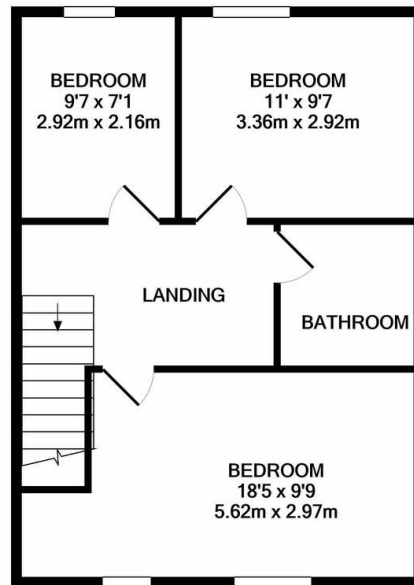

1ST FLOOR
APPROX. FLOOR
AREA 481 SQ.FT.
(44.7 SQ.M.)

FLOOR PLAN BY PHILLIPS GEORGE
TOTAL APPROX. FLOOR AREA 837 SQ.FT. (77.8 SQ.M.)

Whilst every attempt has been made to ensure the accuracy of the floor plan contained here, measurements of doors, windows, rooms and any other items are approximate and no responsibility is taken for any error, omission, or mis-statement. This plan is for illustrative purposes only and should be used as such by any prospective purchaser. The services, systems and appliances shown have not been tested and no guarantee as to their operability or efficiency can be given
Made with Metropix ©2021

| Energy Efficiency Rating | | | |
|--------------------------|---------------|---------|-----------|
| Score | Energy rating | Current | Potential |
| 92+ | A | | |
| 81-91 | B | 81 B | 81 B |
| 69-80 | C | | |
| 55-68 | D | | |
| 39-54 | E | | |
| 21-38 | F | | |
| 1-20 | G | | |

- Three Bedrooms
- Mid Town House
- Parking Space
- Downstairs W.C.
- Convenient Location
- Modern Property
- Breakfast Kitchen
- Pleasant Rear Garden

phillips george | sales & lettings

Agents Note: Whilst every care has been taken to prepare these sales particulars, they are for guidance purposes only. All measurements are approximate and for general guidance purposes only and whilst every care has been taken to ensure their accuracy, they should not be relied upon and potential buyers are advised to recheck the measurements

46 Long Street, Wigston, Leicestershire, LE18 2AH

info@phillipsgeorge.co.uk
0116 216 8178

