



Black and White
CLEARLY A BETTER SERVICE

12 TUDOR CROFT, BIRMINGHAM, B37 5HP
OFFERS OVER £145,000





12 Tudor Croft

- 3 Bedrooms
- Mid-Terrace
- £750 - £800 pcm
- Brand New Kitchen, living room, bathroom, boiler and central heating
- UPVC Double Glazing throughout

This 3 bed room Mid terrace house in Chelmsley Wood would make a fantastic investment property, achieving £750pcm. This house has been recently renovated with brand new kitchen, living room and bathroom as well as having a new boiler and central heating. In the vicinity of schools, shops and major transport links.

Ground Floor

Front Garden

Grass area, footpath to front door

Entrance Hall

Wall mounted radiator, carpeted stairs, door to

:



Living Room 4.51m (14'9") x 3.92m (12'10")

Window to front, wall mounted radiator, bi-fold door to kitchen diner

Kitchen/Diner 5.21m (17'1") x 2.00m (6'7")

Brand new kitchen, matching base and eye level units, cooker included, extractor fan, tiling to wall, grey wood effect flooring, Window to rear, wall mounted radiator, sliding glass door to rear, door to:

Pantry 1.75m (5'9") x 1.20m (3'11")

Garden

Patio, built in shed, walled planting area at rear.

First Floor

Landing

Fitted carpet, storage area, Doors to:

Bedroom 1 4.01m (13'2") x 2.77m (9'1")

Window to front, wall mounted radiator.

Bedroom 2 4.15m (13'7") x 2.77m (9'1")

Window to rear, wall mounted radiator.

Bedroom 3 2.35m (7'8") x 2.00m (6'7") plus 1.78m (5'10") x 1.78m (5'10")

Window to front, wall mounted radiator, built in storage and wardrobe.

Bathroom

Opaque Window to rear, heated towel rail, bath/shower toilet, wash basin, tiled walls, vinyl floor.







Ground Floor

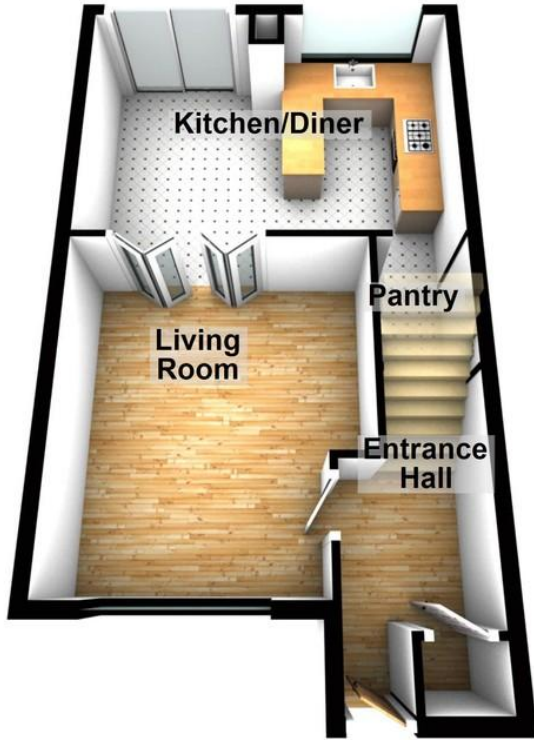

First Floor

