

Because life is

Petty
Real™

For
Sale



Apartment 403 Stephen
House Bethesda Street
Burnley BB11 1PR

£450 PCM



Key Features:

- Luxurious 1 bed apartment
- One double bedroom
- LED spot lighting
- In the heart of Burnley town centre
- Please call 01282 417775 to arrange a viewing
- Lounge & modern fitted kitchen
- Three piece bathroom suite
- Digitalised radiators
- Deposit £450
- NO SMOEKRS

Tenure:

EPC Rating: E

Council Tax Band: A



1 BEDROOM Apartment - Conversion

GROUND FLOOR
40.6 sq.m. (438 sq.ft.) approx.

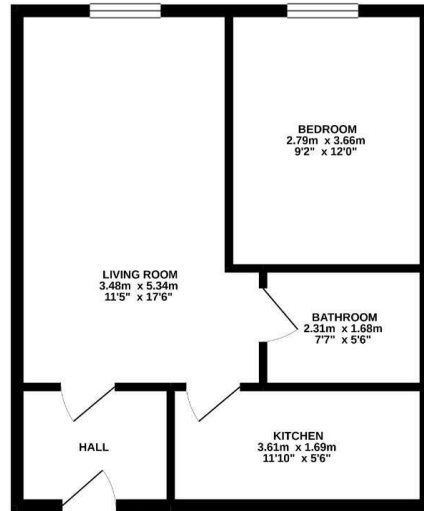

TOTAL FLOOR AREA: 40.6 sq.m. (438 sq.ft.) approx.
Whilst every attempt has been made to ensure the accuracy of the floor plan, measurements of rooms, fixtures, fittings and appliances are approximate and should be used as a guide only. The actual services, appliances and fittings may vary from those shown on the plan and the landlord does not warrant or guarantee as to their availability or efficiency can be given.
March 2023 (12/23)

Main Description:

One bed luxurious apartment located within Stephen House representing a wonderful opportunity to rent within what will become an iconic development that is sure to be at the forefront of further transformation of a rapidly evolving town.

Stephen House is situated in the heart of Burnley Town Centre providing close proximity to shops, coffee shops, restaurants and the University of Central Lancashire. Local and national transport links include the M65 motorway and Burnley train station with links to Manchester City Centre in just over 1 hour.

This one-bedroom apartment has been converted to an exceptional standard and comprises of entrance hallway, lounge, modern fitted kitchen with a range of matching wall and base units finished off in white high gloss providing a minimalist and contemporary feel with coloured splashbacks adding a touch of style and built-in oven and hob, one double bedroom and a three-piece bathroom suite with large walk-in open shower, beautifully finished with natural-stone effect porcelain tiles, providing an opulent finish rarely seen in apartments.

Additionally, it is finished off in matt white throughout with matching joinery, LED spot lighting and digitised radiators.

NO SMOKERS



IMPORTANT: We would like to inform prospective purchasers that these sales particulars have been prepared as a general guide only. A detailed survey has not been carried out, nor the services, appliances and fittings tested. Room sizes should not be relied upon for furnishing purposes and are approximate. If floor plans are included, they are for guidance only and illustration purposes only and may not be to scale. If there are any important matters likely to affect your decision to buy, please contact us before viewing the property