



Jordan Fishwick

MANCHESTER
Stonebridge House



**Stonebridge House,
Manchester M1 3GB**
£950 Per calendar month



The Property

Available Early June. This spacious top floor, two double bedroom apartment with ensuite bathroom to master bedroom, also benefits from a separate kitchen and generous sized balcony. The apartment has been recently furnished with brand new furniture and is ideal for anyone who wants city centre living with plenty of space. The apartment benefits from a very central location, just off Whitworth street and within short walking distance to Piccadilly train station, Oxford road and the Manchester University campuses. No parking. Council Tax Band D. No pets.

Directions

- Available Early June
- Top Floor
- Two Double Bedrooms
- Ensuite & Bathroom
- Separate Kitchen
- Balcony
- Prime Location
- Close To Oxford Rd
- Short Walk To Piccadilly
- Council Tax Band D

Postcode - M1 3GB

EPC Rating - D

Floor Area - sq ft

Local Authority - Manchester Council

Council Tax - Band D

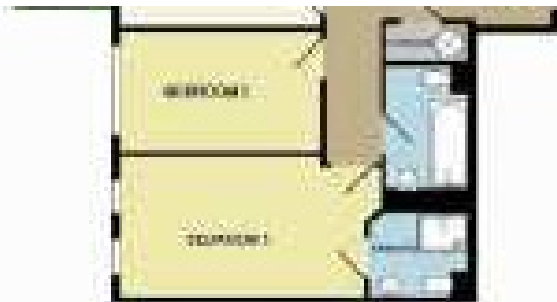



These particulars are believed to be accurate but they are not guaranteed and do not form a contract. Neither Jordan Fishwick nor the vendor or lessor accept any responsibility in respect of these particulars, which are not intended to be statements or representations of fact and any intending purchaser or lessee must satisfy himself by inspection or otherwise as to the correctness of each of the statements contained in these particulars. Any floorplans on this brochure are for illustrative purposes only and are not necessarily to scale.

Offices also at:
Chorlton | Didsbury | Disley | Glossop | Hale | Macclesfield | Manchester | Sale | Wilmslow | Withington

68 The Arches, Whitworth Street West, Manchester, M1

0161 833 9499

manchester@jordanfishwick.co.uk
www.jordanfishwick.co.uk