



Narborough Road South,

Leicester, Leicestershire, LE3 2LD

£950 PCM



NEWTON FALLOWELL PRESENTS A NEWLY REFURBISHED THREE BEDROOM DETACHED PROPERTY ON NARBOROUGH RD SOUTH, WITH GOOD LINKS TO MOTORWAY, LEICESTER CITY CENTRE, FOSSE PARK, AND MERIDIAN LEISURE PARK.

Benefiting from gas central heating (combi boiler), double glazing, garage and rear garden.

Comprising entrance porch & hall, living room & dining room, UPVC doors to the rear garden and newly refurbished kitchen. Annex with WC and wash-hand basin. On the first floor are three double bedrooms & newly refurbished family bathroom / WC separate.

To the front of the property is off-road parking in the form of a driveway for at least two cars.

Available now.

ACCOMMODATION

ENTRANCE HALLWAY

KITCHEN

RECEPTION ROOM 1

RECEPTION ROOM 2

STAIRS & LANDING

BEDROOM 1

BEDROOM 2

BEDROOM 3

BATHROOM

OUTBUILDING WITH WC

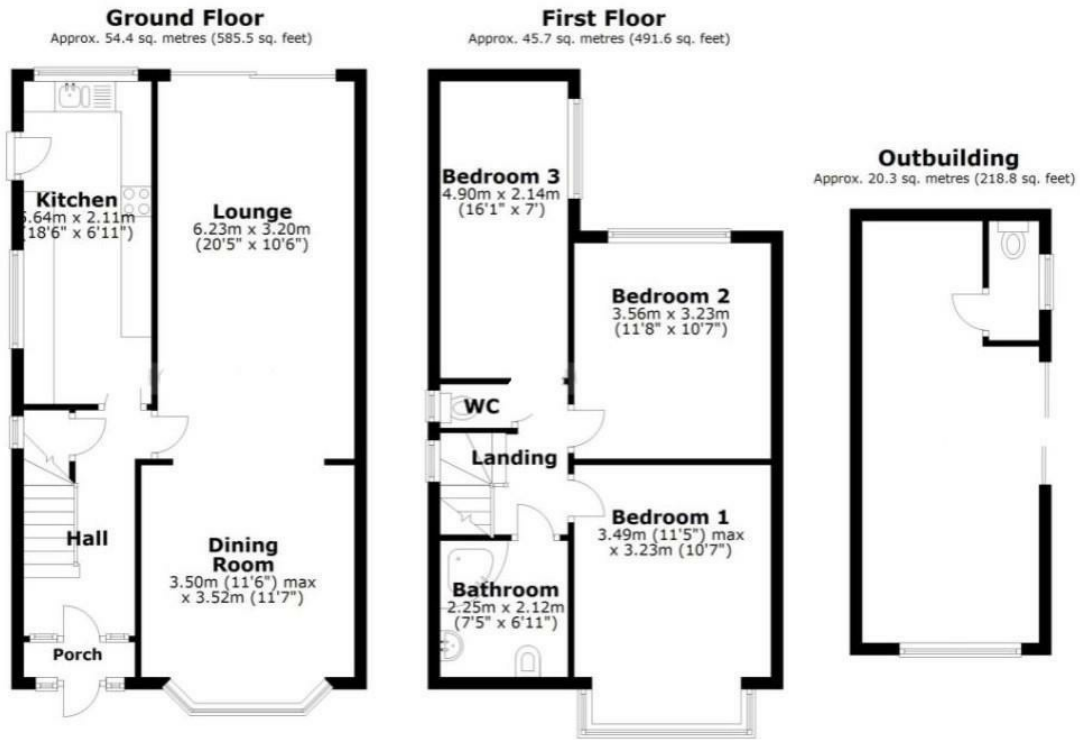

Energy Efficiency Rating		Current	Potential
Very energy efficient - lower running costs			
(92 plus) A			78
(81-91) B			
(69-80) C			
(55-68) D		56	
(39-54) E			
(21-38) F			
(1-20) G			
Not energy efficient - higher running costs			
England & Wales		EU Directive 2002/91/EC	

Environmental Impact (CO ₂) Rating		Current	Potential
Very environmentally friendly - lower CO ₂ emissions			
(92 plus) A			78
(81-91) B			
(69-80) C			
(55-68) D			
(39-54) E			
(21-38) F			
(1-20) G			
Not environmentally friendly - higher CO ₂ emissions			
England & Wales		EU Directive 2002/91/EC	



t: 01163660990 e: oadby@newtonfallowell.co.uk

www.newtonfallowell.co.uk