



Northgate

Darlington DL1 1TL

£450 Per Calendar Month







Reposi

Rent without a deposit

This footer paragraph is an example only and should not be relied upon as complying with current legislation. These particulars, whilst believed to be accurate are set out as a general outline only for guidance and do not constitute any part of an offer or contract. Intending purchasers should not rely on them as statements of representation of fact, but must satisfy themselves by inspection or otherwise as to their accuracy. No person in this firm's employment has the authority to make or give any representation or warranty in respect of the property.

Northgate

Darlington DL1 1TL



- One bedroom
- Town Centre Living
- Completely Refurbished

- Apartment
- Open plan living
- Quality Fixtures And Fittings

- Second Floor
- Modern throughout
- EPC Rating D

NO DEPOSIT OPTION AVAILABLE.

A completely refurbished stylish one bed apartment located in a prime location in Darlington town centre.

The apartment would ideally suit the needs of a tenant looking for low maintenance, modern open plan town centre living in the heart of Darlington town centre.

In brief the apartment comprises : entrance hallway, open plan kitchen and living area, double bedroom and good size bathroom.

The apartment offers brand new high quality fixtures and fittings including washer, fridge/freezer, ceramic hob, oven and extractor, kitchen island and 2 bar stools and all blinds and shutters.

An early viewing is highly recommend.

Hall

With door to the side, audio intercom entry system, laminate flooring with access to all rooms

Lounge/Kitchen

19'7 x 9'8 (5.97m x 2.95m)

With two upvc double glazed windows to the front, fitted with a range of wall, base and drawer units, contrasting work surfaces, integrated fridge/freezer, washer, stainless steel sink unit, electric hob, oven and stainless steel extractor, laminate flooring and radiator.

Bedroom

13'1" x 10'7 (3.99m x 3.23m)

A good size double bedroom with double glazed window to the rear, laminate floor and radiator.

Bathroom

7'7" x 6'7" (2.320 x 2.017)

Fitted with a suite comprising, shower cubicle, low level wc, wash hand basin, tiled flooring, part tiled walls, extractor, towel rail and ceiling spotlights

Communal

The apartment shares a communal area where bins and bicycles can be stored.

Reposit - Rent Without a Deposit

This property is available to tenants using an alternative to the traditional deposit (bond) of 5 weeks' rent.

Using Reposit, tenants are only required to pay the equivalent of 1 week's rent as an alternative to paying the traditional deposit of 5 weeks' rent. There is no need to pay a deposit or bond. This is a one-off, non-refundable payment.

Please note that just like a traditional deposit, you are still liable for any valid, end of tenancy charges. The difference with Reposit is that you keep control of your money and only pay these if they actually occur at the end of your tenancy, rather than paying at the start.

Holding Deposit

All of our rental properties require a Holding Deposit equivalent to 1 week's rent. The Tenant is entitled for this Holding Deposit

to be repaid within 15 calendar days of their application proceeding. However, in most cases we hope to repay this to the Tenant on the day you move in and this will be deducted from your first month's rent. This will need to be agreed with the Tenant during the application process.

You will lose your Holding Deposit if any of the following occurs:

1. You give us false or misleading information. For example, incorrect salary/income details or you fail to tell us about a CCJ.
2. You fail a Right to Rent check and are not eligible to reside in the UK.
3. You withdraw your application.
4. You drag your feet during the application process.

Deposit (Bond)

The deposit (bond) amount is equivalent to 5 weeks' rent.

Venture Properties

We are Darlington's leading letting agent, letting more properties than any other agent in Darlington, and are proud to be an independent company. What does this mean for tenants? If the property is managed by Venture Properties, you will be assigned your own Property Manager who will look after you during the duration of your tenancy. The staff will be located in our Darlington office and not in a call centre out of town, which you will get with some other agents.

GROUND FLOOR

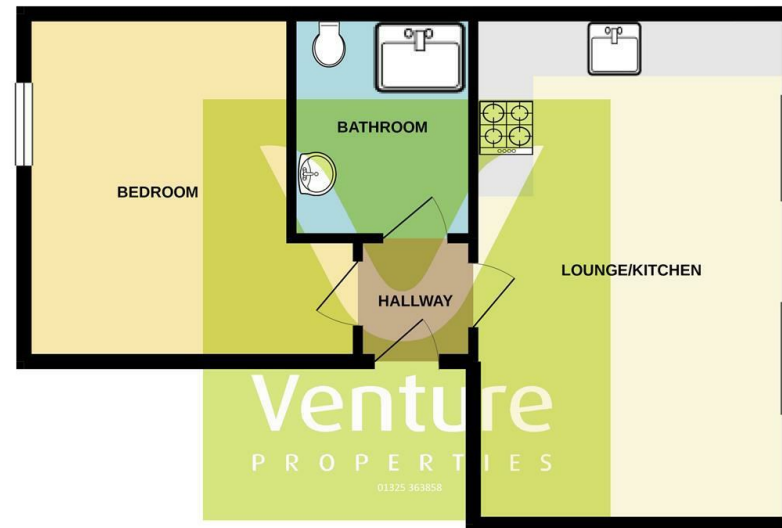

Whilst every attempt has been made to ensure the accuracy of the floorplan contained here, measurements of doors, windows, rooms and any other items are approximate and no responsibility is taken for any error, omission or mis-statement. This plan is for illustrative purposes only and should be used as such by any prospective purchaser. The services, systems and appliances shown have not been tested and no guarantee as to their operability or efficiency can be given.
Made with Metagen ©2020

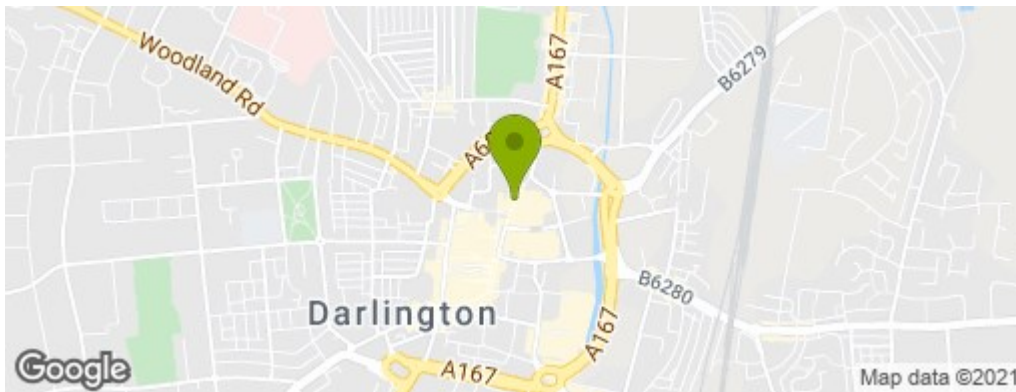

Property Information

01325 363858

45 Duke Street, Darlington, County Durham, DL3 7SD
enquiries@venturepropertiesuk.com