

Property Description

Located in the heart of Romford Town Centre and next door to the Romford Sport and Leisure centre. This two-bedroom second floor apartment is decorated to a good standard throughout. Offering two good size bedrooms, modern shower room and a open plan kitchen/living space. This property is perfect as a first-time purchase or your next investment!

Second Floor

Kitchen/Living Space – 9'04" x 17'05"

Shower Room – 6'11" x 5'10"

Bedroom One – 12'06" x 9'09"

Bedroom Two – 12'06" x 6'01"

Leasehold

Disclaimer: Information provided about this property does not constitute or form part of an offer or contract, nor may be it be regarded as representations. All interested parties must verify accuracy and your solicitor must verify tenure/lease information, fixtures & fittings and, where the property has been extended/converted, planning/building regulation consents. All dimensions are approximate and quoted for guidance only as are floor plans which are not to scale and their accuracy cannot be confirmed. Reference to appliances and/or services does not imply that they are necessarily in working order or fit for the purpose.

"Our Service is Key"

**2 Bedroom
Apartment
£250,000**

Verve Apartments, Mercury Gardens, Romford, RM1 3FD



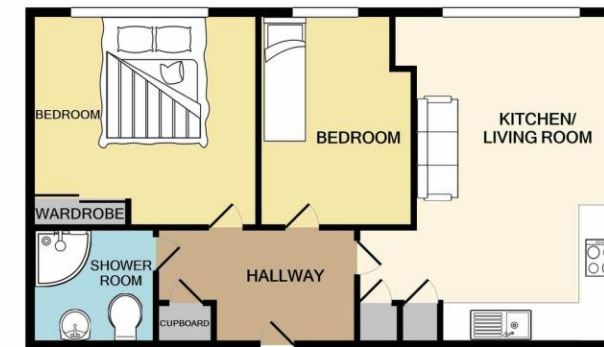

Whilst every attempt has been made to ensure the accuracy of the floor plan contained here, measurements of doors, windows, rooms and any other items are approximate and no responsibility is taken for any error, omission, or mis-statement. This plan is for illustrative purposes only and should be used as such by any prospective purchaser. The services, systems and appliances shown have not been tested and no guarantee as to their operability or efficiency can be given.
Made with Metropix ©2021