

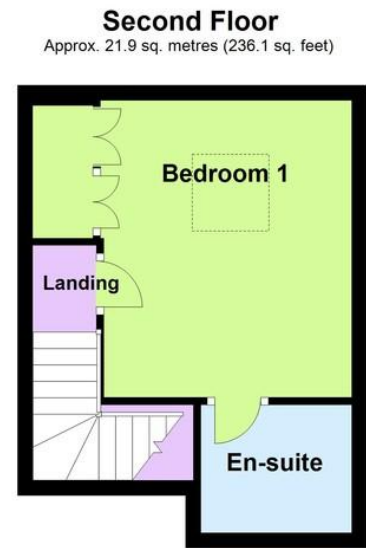

- Available Approx. Mid June
- End of Terrace House
- 3 Bedrooms
- Ground Floor Cloakroom
- Modern Kitchen
- Family Bathroom/WC
- En Suite Shower Room/WC
- Private Off Road Parking
- EPC Rating: - TBA

43a Manor Road, East Preston BN16 1QA

£1,400 pcm

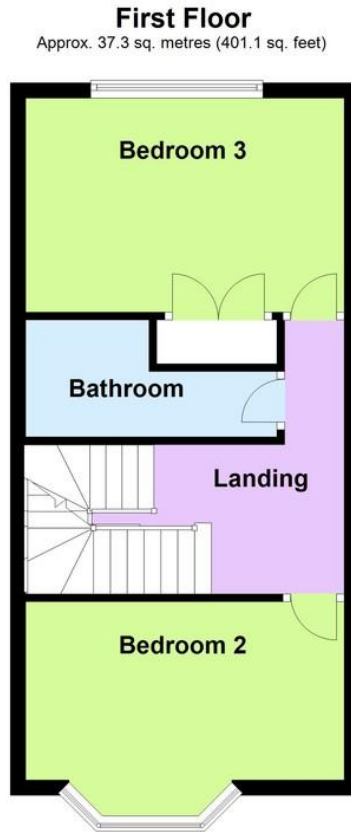
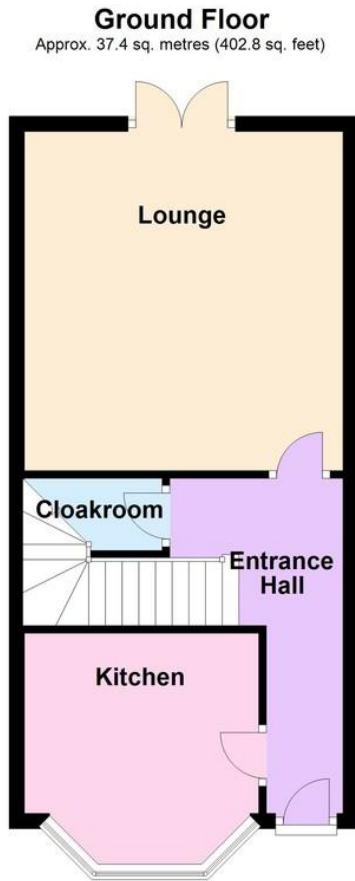

Total area: approx. 96.6 sq. metres (1039.9 sq. feet)

ENTRANCE HALL

KITCHEN

10' x 7' 8" (3.05m x 2.34m)

CLOAKROOM

LOUNGE

14' 6" x 13' 11" (4.42m x 4.24m)

FIRST FLOOR LANDING

BEDROOM 2

13' 11" x 7' 8" (4.24m x 2.34m)

BEDROOM 3

14' x 9' 1" (4.27m x 2.77m)

BATHROOM/WC

SECOND FLOOR LANDING

BEDROOM 1

13' 11" x 12' 8" (4.24m x 3.86m)
including depth of wardrobe

EN SUITE SHOWER/WC

The information and measurements contained within these details are for guidance only and do not form part of any contract.

EPC TO FOLLOW



90 THE STREET, RUSTINGTON, WEST SUSSEX, BN16 3NJ

lettings@hawkemetcalf.co.uk

www.hawkemetcalf.co.uk

01903 850450