



Warwick Building,
London, SW11 8NL
£330 Per Week

GARTON JONES.COM



Chelsea Bridge Wharf,
Warwick Building,
London, SW11 8NL

£330 Per Week



Lovely one bedroom property located on the eighth floor of the Warwick Building in Chelsea Bridge Wharf. Spacious open plan living/kitchen area with full length windows from which you can see views of the iconic Battersea Power Station. Wooden flooring throughout living room and bedroom. Bedroom is of a generous size with a separate bathroom. Good storage space throughout.

Chelsea Bridge Wharf is London's most glamorous riverside development located just 0.75 miles from Sloane Square and adjacent to the wide open spaces of Battersea Park and the River Thames. 24 hour concierge service and security service.

- One Bedroom, One Bathroom
- Views facing Battersea Power Station
- Open plan Kitchen and Reception area
- 531 sq ft
- Eight floor
- 24 hour Concierge
- Excellent travel Links
- Close to Central London

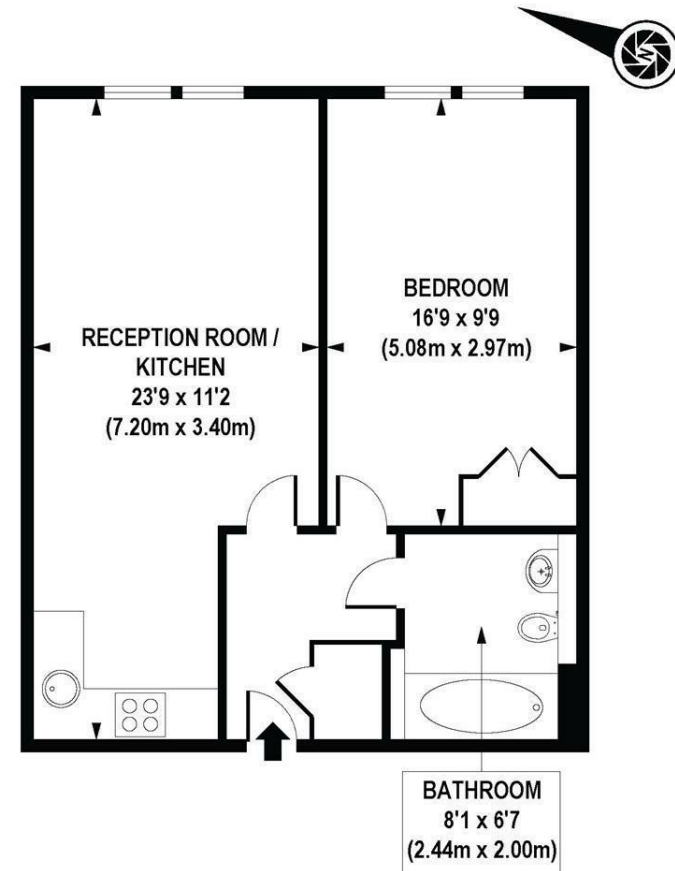

APPROXIMATE GROSS INTERNAL AREA 531 sq. ft / 49.30 sq. m

GARTON JONES.COM

3 Oswald Building
374 Queenstown Road
London
SW11 8NU

sales@gartonjones.co.uk
0207 622 8800
www.gartonjones.com