



Larkspur Drive, Chandler's Ford, SO53 4HU

Jonathan Rees



We are pleased to offer this two double bedroom terraced house in a quiet cul-de-sac in Knightwood Park, Chandler's Ford. On the ground floor is the entrance hallway, kitchen at the front of the property and the lounge/diner at the rear with French doors to the attractive westerly facing rear garden with raised decked area. Gate at the rear leading to the tandem off road parking for two cars. Upstairs is bedroom one with an en-suite shower room, a further double bedroom with built in wardrobes and the bathroom. Benefitting from the excellent catchment for Knightwood Primary and Thornden Secondary schools.

£265,000

Terraced Home
Two Double Bedrooms
En-Suite
Westerly Facing Rear Garden
Quiet Location
Cul-de-Sac
Tandem Parking for 2 Cars
Knightwood and Thornden Catchments

ENTRANCE HALL

KITCHEN 10' 1" x 6' 1" (3.07m x 1.85m)

LOUNGE/DINER 17' 3" x 12' (5.26m x 3.66m)

BEDROOM ONE 12' x 8' 7" (3.66m x 2.62m)

ENSUITE

BEDROOM TWO 8' 7" x 8' 6" (2.62m x 2.59m)

BATHROOM

REAR GARDEN

TANDEM OFF ROAD PARKING



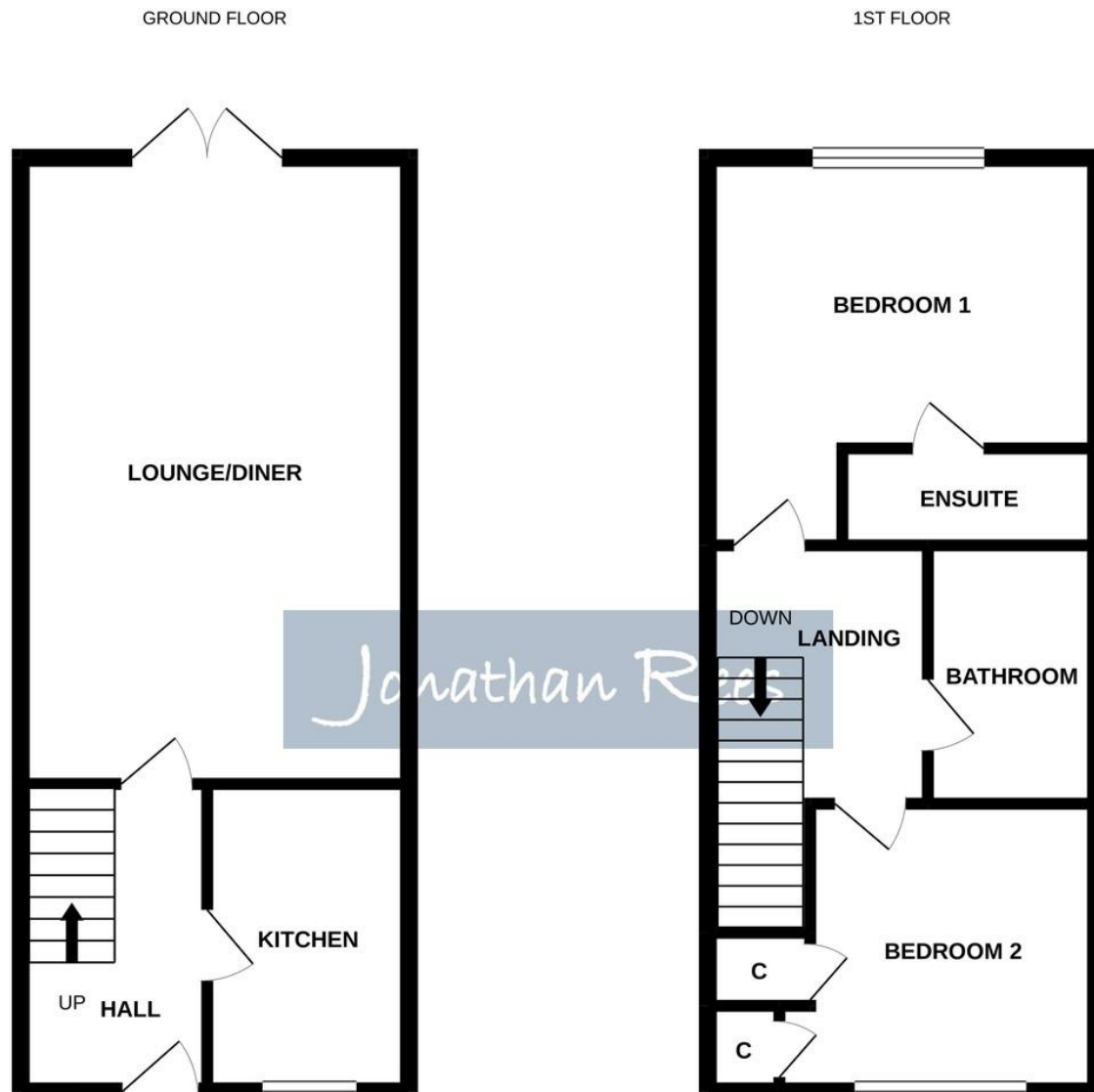

Key Information

LOCAL AUTHORITY INFORMATION

C

LOCAL SCHOOLS INFORMATION
 Primary: Knightwood/St Francis C of E
 Secondary: Thornden School

EPC RATING
 TBC

EPC GRAPH TO FOLLOW

IMPORTANT NOTICE

These details have been prepared and issued in good faith and do not constitute representations of fact or form part of any offer or contract. Please note that we have not carried out a structural survey of the property, nor have we tested any of the services or appliances. All measurements are intended to be approximate only. All photographs show parts of the property as they were at the time when taken. Any reference to alterations or particular use of the property wherever stated, is not a statement that planning, building regulations or other relevant consent has been obtained. Floorplan. All measurements, walls, doors, windows, fittings and appliances, their sizes and locations are shown conventionally and are approximate only and cannot be regarded as being a representation either by the seller or his Agent.

100 Winchester Road, Chandler's Ford, Hampshire, SO53 2GJ

t: 023 8027 6500

e: sales@jonathanrees.com

