

Powered by Giraffe360

Approximate net internal area: 700.88 ft² / 65.11 m²
While every attempt has been made to ensure accuracy, all measurements are approximate.
not to scale. This floor plan is for illustrative purpose only and should be used as such by any prospective tenant or purchaser.

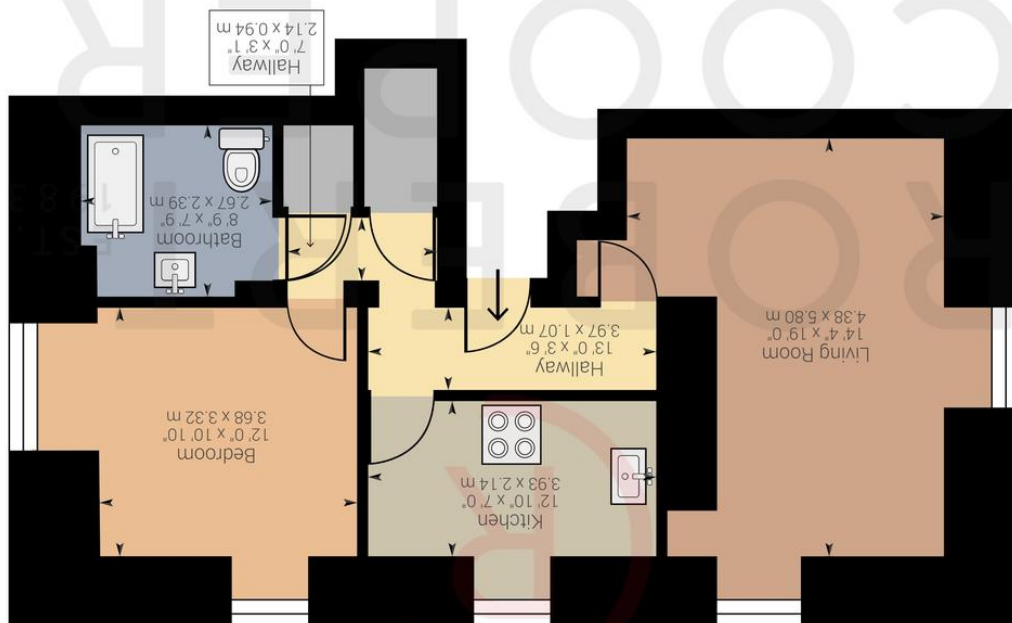

COTTAGE CLOSE, HA2 0HG

£275,000





A unique one bedroom top floor apartment set on this quiet cul-de-sac in the heart of Harrow offering easy access to the prestigious Harrow-On-The-Hill. Features include allocated parking, modern interiors, 700 Sq Ft living accommodation, no upper chain and separate kitchen and living area. The property is 0.2 miles away from Harrow-On-The-Hill, 0.6 miles away from South Harrow high street and station (Metropolitan & Piccadilly Line) and 1 mile from Harrow town centre and station (Metropolitan & Piccadilly Line).

Top Floor

One Double Bedroom

700 Sq Ft Living Accomodation

Modern Interiors

Separate Kitchen & Living Area

Allocated Parking

No Upper Chain

Walking Distance Met/Piccadilly Line

