



East Road, Colchester, CO5 8TA

This charming four-bedroom detached house is situated in the highly desirable Mersea Island. Located to the south of Colchester with local amenities surrounding as well as a well-rated primary school, country park, and excellent pub/restaurant. Surrounded by peaceful and stunning rural views, yet a short drive from the heart of West Mersea.

The accommodation internally offers a plethora of contemporary-style character features and space. The ground floor presents an entrance hall with storage options, leading into a light and airy sitting room with dark wood flooring. The generous lounge provides an additional reception room, carpeted throughout. Modern and impressive, the kitchen/dining area creates the perfect hub for entertaining. With gorgeous solid walnut countertops, an island, and an integrated eye-level double oven. Throughout both the kitchen and dining area, the house boasts underfloor heating and triple-glazed bi-folding doors out to the garden. A master bedroom provides built-in wardrobes and benefits from en-suite facilities with a jacuzzi bath and additional shower unit. The second floor also comprises of another two double rooms and a further single room with an integrated wardrobe.

An outbuilding boasts a generous, functioning home office with a utility area and benefits from a W.C, ideal for working from home. This is attached to the garage, providing secure parking. The property also boasts extensive off-road parking. Call Oakheart today to book a viewing, or for further information!

- Four Bedroom Detached House
- Refurbished Kitchen
- Separate Office with Utility Area and W.C
- Master Bedroom with En-Suite
- Separate Lounge and Sitting Room
- Garage and Ample Off-Road Parking
- Under Floor Heating in Kitchen/Diner
- Located in Mersea Island
- Local Amenities Close By
- Beautiful Surrounding Views

Guide price £750,000



GROUND FLOOR

1ST FLOOR

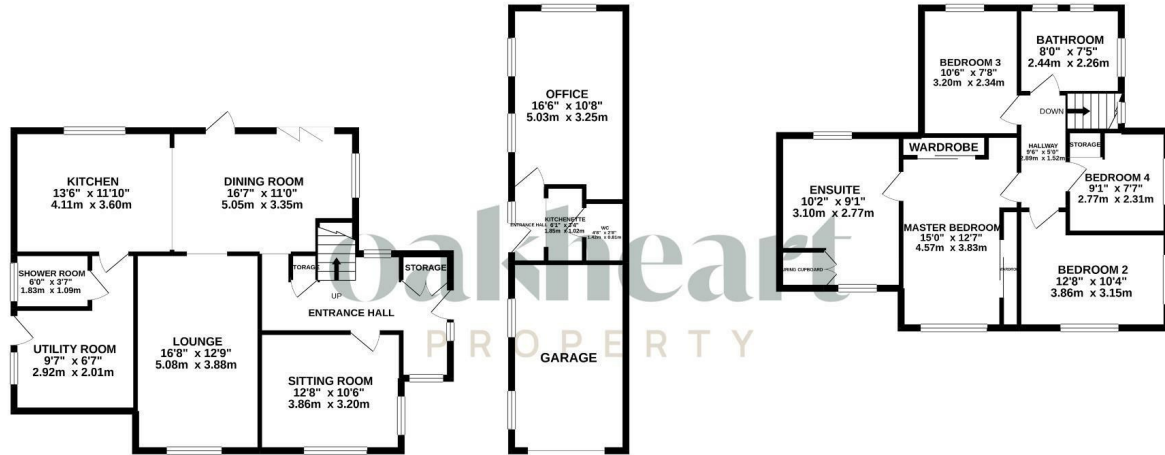

Whilst every attempt has been made to ensure the accuracy of the floorplan contained here, measurements of doors, windows, rooms and any other items are approximate and no responsibility is taken for any error, omission or mis-statement. This plan is for illustrative purposes only and should be used as such by any prospective purchaser. The services, systems and appliances shown have not been tested and no guarantee as to their operability or efficiency can be given.
Made with Metropix ©2021

