

5 Boughton Avenue, Worcester, WR2 5EP

A very well presented shared house available for both professionals or students there are four double rooms with en-suite shower rooms furnished to a high standard. Tenants share a well appointed kitchen and living room, bills are included in the rent with the exception of council tax. EPC D

www.platinum-property.co.uk

£550 pcm
Student Room

PLATINUM PROPERTY AGENTS 15-17 St Johns, Worcester, WR2 5AE

T: 01905 740580

Email: worcester@platinum-property.co.uk

Property Location

Known as the village in the city, St Johns is situated on the western side of the River Severn and provides road links to Hereford and Leominster to the west, Malvern to the South and access to the M5 North via Worcester City centre or Holt Heath and M5 South via the southern by-pass. Worcester City centre is to the east of the river bridge and is accessible on foot or by Bus. Directions - From Bromyard Road turn left into Boughton Avenue by foot where number 5 can be found on the left.

Property Details

The property has four double En Suite rooms, tenants share a well appointed dining kitchen and a communal lounge.

Outside there is a small shared patio garden and parking is available.

RENT

Room 1 - £550pcm - Bills Inclusive

Room 2 - £550pcm - Bills Inclusive

Room 3 - £550pcm - Bills Inclusive

Room 4 - £550pcm - Bills Inclusive

Important Information

Deposit - £300

Council Tax Band - Exempt with qualifying certificate

Guarantor - A guarantor is usually required however some of our landlords are willing to be flexible subject to circumstances.

Agreements - Individual 11 months Assured Shorthold Tenancy agreements from 1st September to 31st July

Inclusive - Where indicated inclusive means the rent quoted usually includes: Electricity, Gas, Broadband, Water Rates and sometimes a Communal room TV Licence.

Furnished - Our student properties are fully furnished in line with the University of Worcester recommendations

Pets - This is a shared house and therefore pets would not be appropriate.

Securing the Property

Having found the property you are looking for; the next step is to make an application.

We will forward to you and your guarantor our application form via e-mail requesting the information we require to verify your suitability for the property.

The property will not be reserved until the application form has been received from you and your guarantor

Our checks include verification of your identity, previous credit history, landlord and employment referencing

together with an affordability assessment. Should you anticipate any issues please highlight these with us in advance to allow us to advise you whether your situation is likely to be accepted by our Landlord.

ON RECEIPT OF YOUR APPLICATION FORM THE PROPERTY WILL NOT BE OFFERED TO ANYONE ELSE HOWEVER THE PROPERTY WILL THEN BE RE-MARKETED IF YOU DO NOT SIGN YOUR TENANCY AGREEMENT WITHIN 7 DAYS OF APPLICATION.

ONCE SIGNED THE PROPERTY IS THEN SECURED FOR YOU AND WILL NOT BE OFFERED TO ANYONE ELSE. LIKEWISE, YOU AND YOUR GUARANTOR ARE LEGAL COMMITTED TO RENT THE PROPERTY FOR THE PERIOD OF THE TENANCY STATED IN THE AGREEMENT.

Successful Applications

The deposit is payable on confirmation that your application has been successful, and the first month's rent is payable before to moving in. All funds must be cleared prior to moving in therefore please allow 5 business days for payments by cheque.

Paying Online;

Payee; Platinum Property Rentals

Ac. No.; 53559610

Sort Code; 20-71-45

Ref; Please use your room number and property address e.g. Rm 1 5 Avenue Road. Do not use your name or "rent" or "deposit" as these are difficult to trace

Paying by Debit Card;

Please call 01905 740580 and a member of staff would be happy to help.

Deposits

The majority of our deposits are held independently by the Deposit Protection Service and are supported by a detailed inventory.

Tenancy Agreements

Initially we usually offer 11 months assured shorthold tenancy which can be renewed for the following year with the agreement of the Landlord.

Tenant's Insurance

At Platinum we would recommend for your protection you obtain Contents Insurance and Accident and Sickness Rent payment cover. Following application, we can introduce you to a suitable profession via Platinum Property Finance to obtain a competitive quotation.

Please contact your local office for further information regarding this property.

Ground Floor

Approx. 61.4 sq. metres (660.9 sq. feet)



First Floor

Approx. 35.2 sq. metres (378.9 sq. feet)

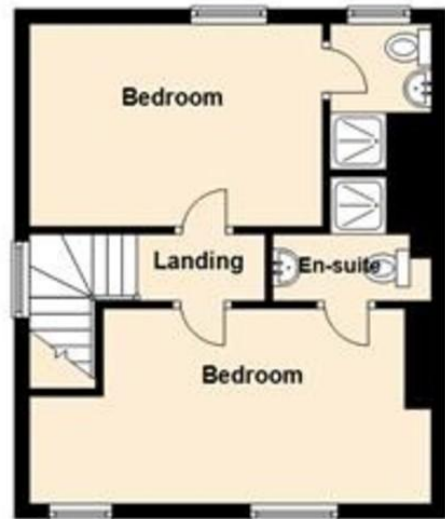

Total area: approx. 96.6 sq. metres (1039.9 sq. feet)

%epcGraph_c_1_400%