



Wades Hill, London

£1,750 PCM

Havilands

the advantage of experience



- Delightful Cottage
- 2 Double Bedrooms
- Feature Fireplaces
- Great location



For more images of this property please visit havilands.co.uk



Delightful 2 double bed, 2 reception cottage just moments walk from Winchmore Hill Green, the station (30 mins Moorgate), Sunday Farmers Market and numerous cafes/restaurants. This property has front lounge, dining room leading to spacious kitchen with courtyard garden. Upstairs there are 2 double bedrooms and a spacious bathroom featuring a shower, slipper bath and feature fireplace. This property comes unfurnished and is available Mid to end of July. Will suit professional couple. Viewing is highly recommended.

For more images of this property please visit havilands.co.uk

GROUND FLOOR 464 sq. ft.
(43.1 sq. m.)

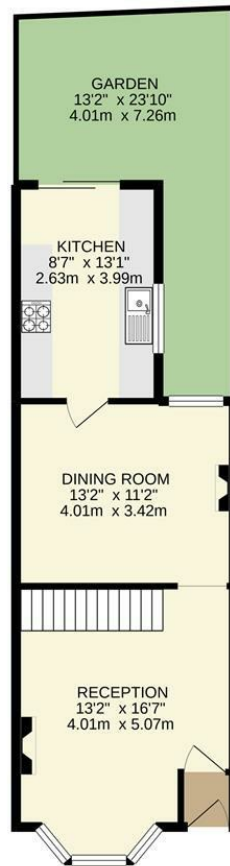

1ST FLOOR 425 sq. ft.
(39.4 sq. m.)

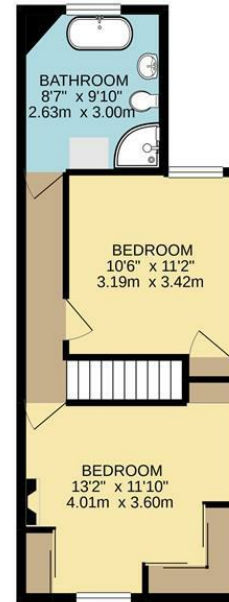

TOTAL FLOOR AREA : 888 sq. ft. (82.5 sq. m) approx.

Whilst every attempt has been made to ensure the accuracy of the floorplan contained here, measurements of doors, windows, rooms and any other items are approximate and no responsibility is taken for any error, omission or mis-statement. This plan is for illustrative purposes only and should be used as such by any prospective purchaser. The services, systems and appliances shown have not been tested and no guarantee as to their operability or efficiency can be given.
Made with Metropix ©2019



havilands | 02088866262

come by and meet the team

30 The Green, Winchmore Hill, London, N21 1AY

Havilands

the advantage of experience