



London Road, Chippenham  
Chippenham, SN15 3AJ

STRAKERS



9f London Road, Chippenham,  
Wiltshire, SN15 3AJ

- TO LET
- BRAND NEW
- ONE BEDROOM
- GROUND FLOOR
- CLOSE TO TRAIN STATION
- OFF STREET PARKING
- UNFURNISHED
- AVAILABLE 1ST JULY 2021

£625 PCM



New to the market-Set within a short distance of the town centre and train station is this newly built ground floor one bedroom apartment with off street parking and patio area. Available 1st July 2021, unfurnished, £625pcm (sorry no pets).

#### Description

Accommodation comprises private entrance, a nice size open living kitchen room with oven, hob and space for a fridge freezer and washing machine. The good sized double bedroom has an outlook to the front with two further sash windows and the shower room is fitted with a large walk-in shower cubicle, pedestal wash hand basin and a W.C. The property also benefits from having gas fired central heating.

The property is most conveniently located on London Road within walking distance of the town centre and mainline Railway station (London Paddington) Further benefits include easy access to the M4. Within minutes you can access Monkton Park, riverside walks and cycle ways. Chippenham itself offers a wide range of amenities including High Street retailers plus supermarkets and retail parks. In addition there is a Leisure Centre with indoor swimming pool, Library, Cinema and public parks.

A minimum contract for this property is 6 months. (Please bring passport OR driving licence & birth certificate with you at time of viewing).



[www.strakers.co.uk](http://www.strakers.co.uk)

Email: [lettings@strakers.co.uk](mailto:lettings@strakers.co.uk)

Tel: 01249 652717

9f London Road, Chippenham, Wiltshire, SN15 3AJ

Illustration for identification purposes only, measurements are approximate, not to scale.  
Plan produced using PlanUp.

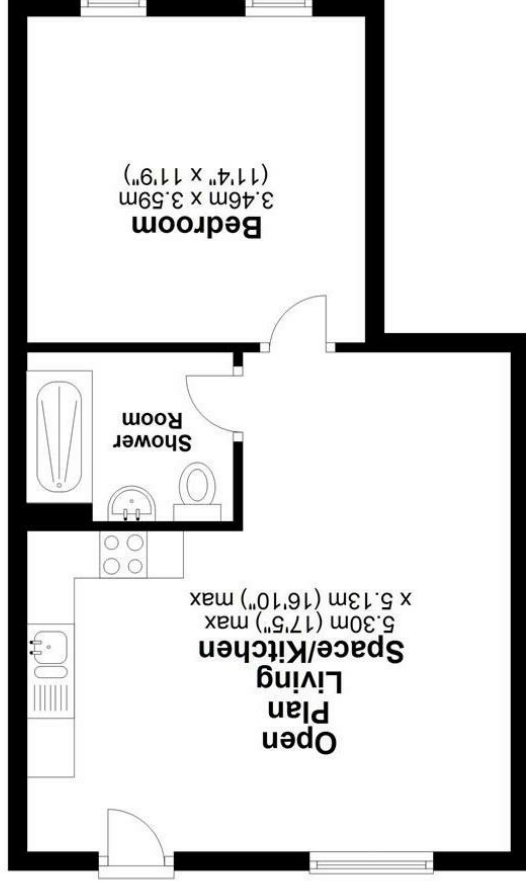

**Floor Plan**  
Approx. 39.9 sq. metres (430.0 sq. feet)