



 2  
Bedrooms

 1  
Bathroom

First floor apartment - Two double bedrooms - Fully fitted Kitchen -  
Lounge with juliette balcony - 2 allocated parking spaces

Located in this sought after development within the ever popular area of Maidenbower this modern 2 double bedroom 1st floor apartment affords generous accommodation comprising of a part tiled bathroom with modern coloured sanitary ware, fitted kitchen with built in appliances including washer dryer, oven hob and hood and fridge freezer. A spacious double aspect lounge carpeted throughout. All shops, public transport and school are but a few minute's walk away, making this apartment truly a gem.

#### ABOUT US:-

Onerent is an independent landlord, and we own or privately manage all of the properties that we offer for rental. We specialise in the provision of comfortable and clean fully furnished rental properties, and you are assured of a service and quality that you will not have previously experienced with either an estate agent or relocation service.

All of our properties are selectively purchased to ensure that our tenants enjoy the very best positions and locations on the rental market with regards to local amenities and travel criteria. We supply accommodation to most of the major corporate entities in the UK, either directly or through most of the business relocation companies, and our experience and client base ensures that your rental experience will be of a standard that is more than acceptable on both a business and private basis.

Please call us on 0800 027 5660, and we will furnish you with all of the information that you require to make your stay as pleasant as possible.

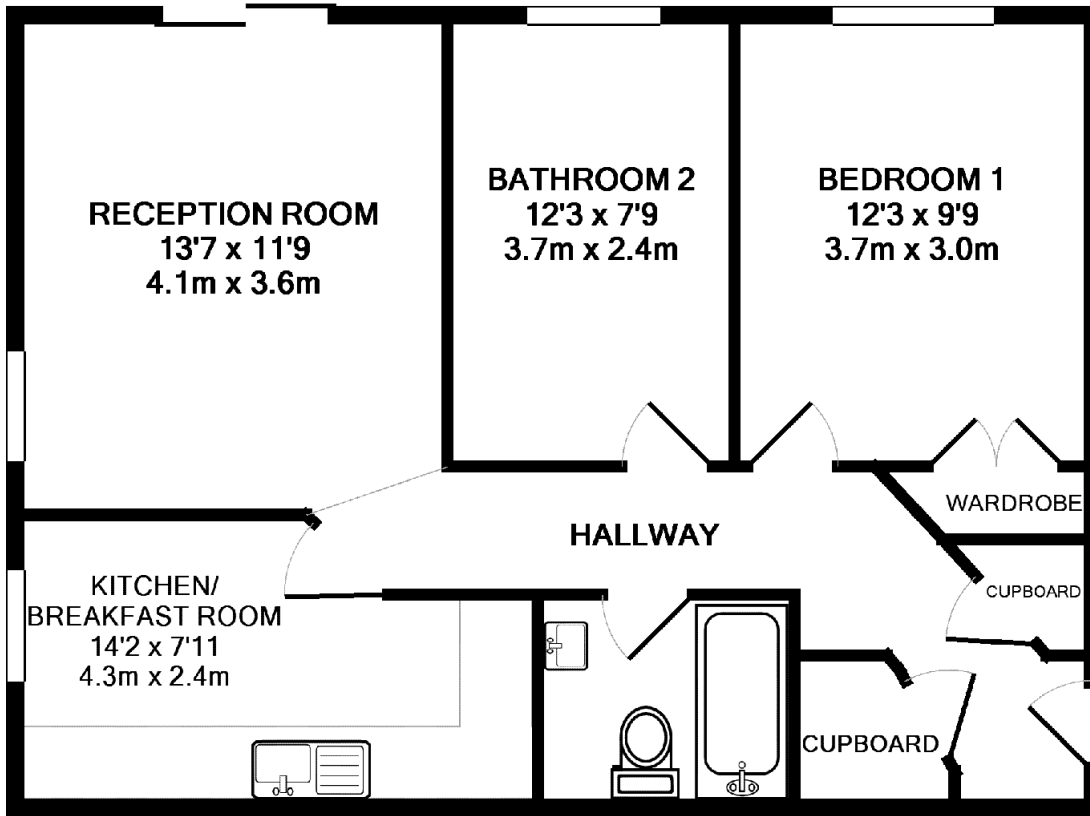

### Energy Efficiency Rating

	Current	Potential
<i>Very energy efficient - lower running costs</i>		
(92-100) <b>A</b>		
(81-91) <b>B</b>		
(69-80) <b>C</b>	76	79
(55-68) <b>D</b>		
(39-54) <b>E</b>		
(21-38) <b>F</b>		
(1-20) <b>G</b>		
<i>Not energy efficient - higher running costs</i>		
England, Scotland & Wales	EU Directive 2002/91/EC 