

Hutton Raufe

Cheltenham GL51 7AQ



Fairmount Road, Cheltenham GL51 7AQ

A spacious three bedroom apartment with period features and log burner within close proximity to Cheltenham Spa Train Station. The property briefly comprises of:- Entrance hall, a sizeable living room / diner which features a log burner and beautiful bay window flooding the apartment with light, a separate kitchen with appliances which include washing machine, fridge / freezer, oven and hob, there are two good sized double bedrooms, a third single bedroom / study and shower room with walk in shower. The apartment further benefits from two garages, first come first serve of road parking and is chain free.





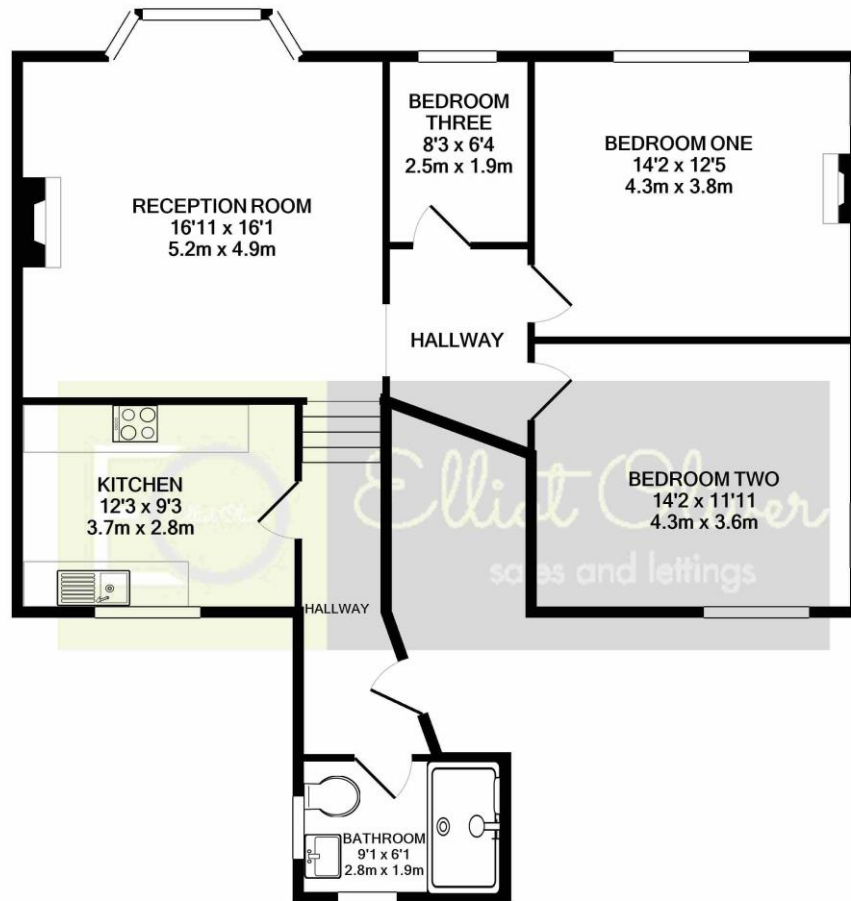

Whilst every attempt has been made to ensure the accuracy of the floor plan contained here, measurements of doors, windows, rooms and any other items are approximate and no responsibility is taken for any error, omission, or mis-statement. This plan is for illustrative purposes only and should be used as such by any prospective purchaser. The services, systems and appliances shown have not been tested and no guarantee as to their operability or efficiency can be given
Made with Metropix ©2021

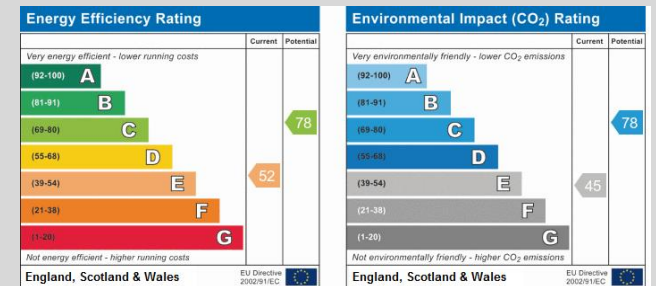

Address:
Fairmount Road
Reference:
Fairmount Road



101 Promenade,
Cheltenham,
Gloucestershire, GL50
1NW
info@elliottoliver.co.uk

Agents Note: Whilst every care has been taken to prepare these sales particulars, they are for guidance purposes only. All measurements are approximate and for general guidance purposes only and whilst every care has been taken to ensure their accuracy, they should not be relied upon and potential buyers are advised to recheck the measurements