

## Denham House, W12

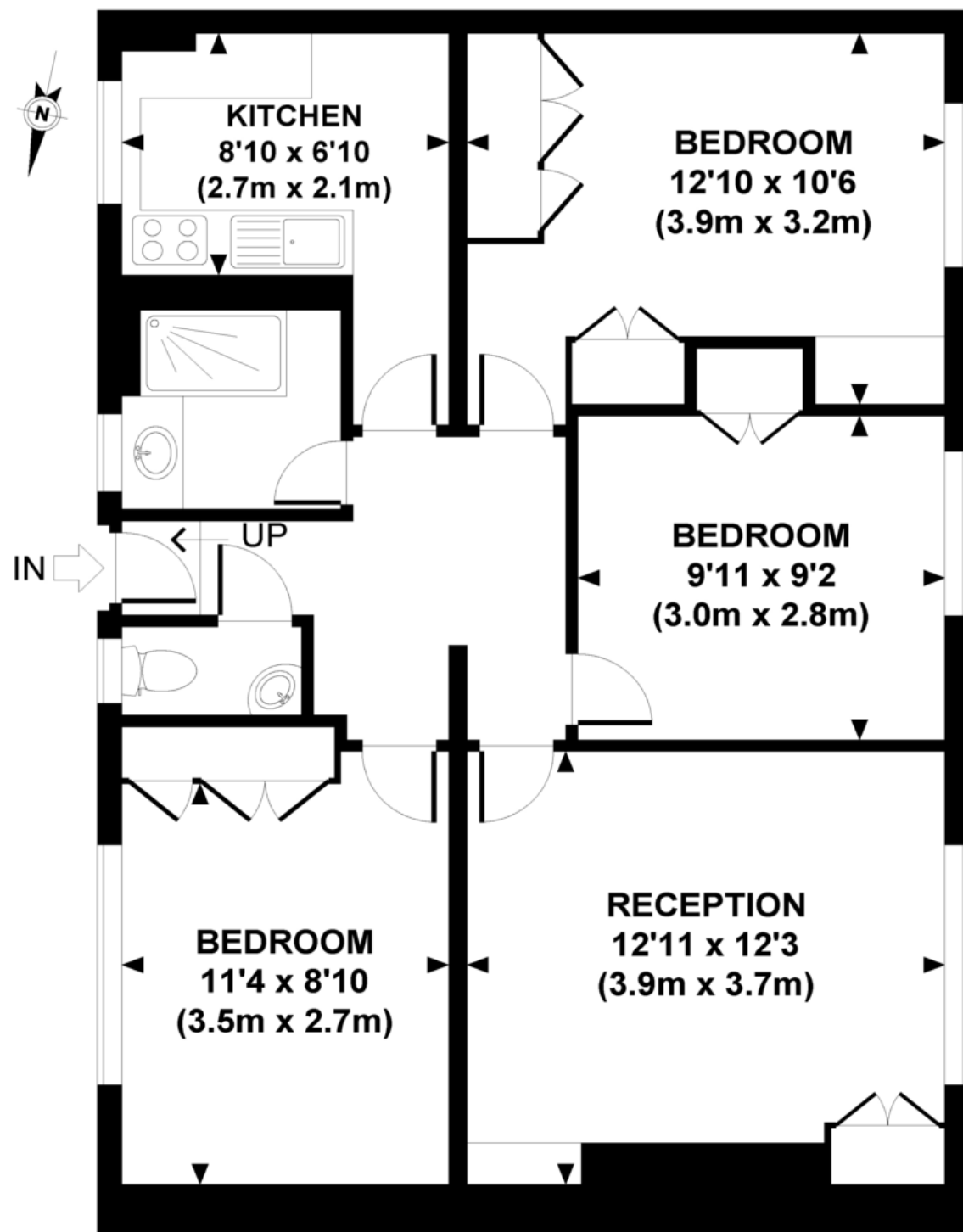

FOURTH FLOOR

APPROXIMATE GROSS INTERNAL AREA 744 SQ FT / 69.1 SQ M

Whilst every attempt has been made to ensure the accuracy of this floor plan; measurements of door, windows, rooms and all other items are approximate. No responsibility is taken for any error, omission or mis-statement. This floor plan is for illustrative purposes only, and should be treated as such.



## White City Estate, London, W12 7PE

£399,000 Leasehold

### Key Features

- Two Bed Apartment
- White City Estate
- Sought After building
- New Windows
- Lift serviced
- 750 sq ft
- Priced To Sell
- No Chain

### Description

A fabulous opportunity to acquire this superb lift serviced spacious 750 sq ft two double bedroom apartment with fabulous views. The property has been exceptionally well maintained throughout and is an ideal investment for a buy to let landlord or first-time buyer.

