



11 Ellingham Road

Shepherds Bush, London, W12 9PR

£1,100 Per Week

Fantastic 4 bedroom family house with double reception, spacious kitchen/breakfast room, two bathrooms and pretty private garden. Located in a quiet residential street, close to Ravenscourt Park and a short walk to Westfield London and Shepherds Bush. Available in mid August, unfurnished.

- 4 BEDROOMS
- DOUBLE RECEPTION
- SPACIOUS KITCHEN BREAKFAST ROOM
- 2 BATHROOMS
- PRETTY GARDEN
- CLOSE TO RAVENSCOURT PARK
- EPC RATING 62
- AVAILABLE MID AUGUST
- UNFURNISHED

Viewing

Please contact our Finlay Brewer - Sales Office on 020 7371 4171 if you wish to arrange a viewing appointment for this property or require further information.

Floor Plan

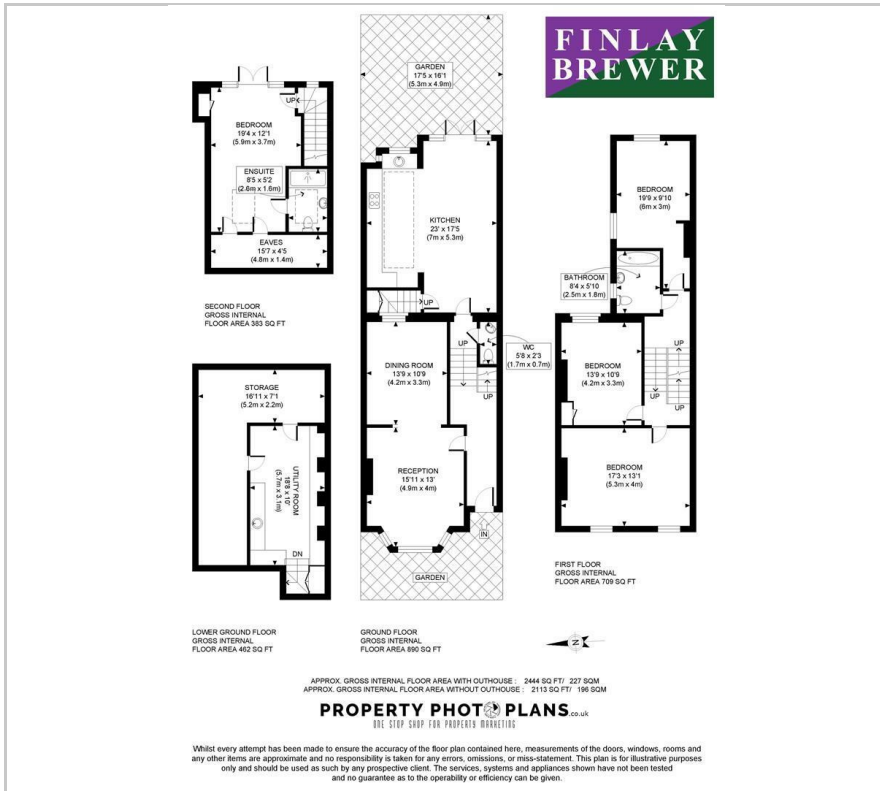

Area Map



Energy Efficiency Graph

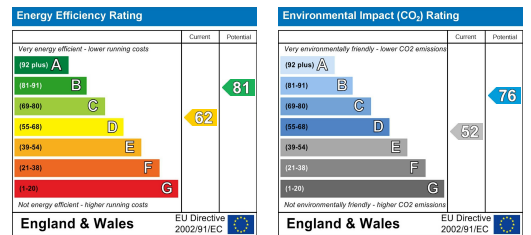

These particulars, whilst believed to be accurate are set out as a general outline only for guidance and do not constitute any part of an offer or contract. Intending purchasers should not rely on them as statements of representation of fact, but must satisfy themselves by inspection or otherwise as to their accuracy. No person in this firm's employment has the authority to make or give any representation or warranty in respect of the property.