



Roman Road, LONDON, E2 0QN
£1,200 PCM

Elms Estates are pleased to be able to offer to the market To Let this lovely one bedroom apartment situated on Roman Road with its multiple shopping facilities and conveniently close to Bethnal Green (Central Line) Tube Station or Stepney Green (District Line) Tube Stations. Situated within the Heart of Bethnal Green with easy access to all of the Restaurants, Bars, Shops, Gyms, Parks, Galleries and Museums this Exciting Area has on offer.

The property offers bright and spacious accommodation with a modern fitted kitchen and shower room as well as gas central heating and double glazing .

The property is offered furnished and is available for immediate occupation. Internal viewing is highly recommended to avoid disappointment. Enquire now to arrange your viewing.



- Exterior
- Bedroom
- Bathroom
- Lounge/Kitchen

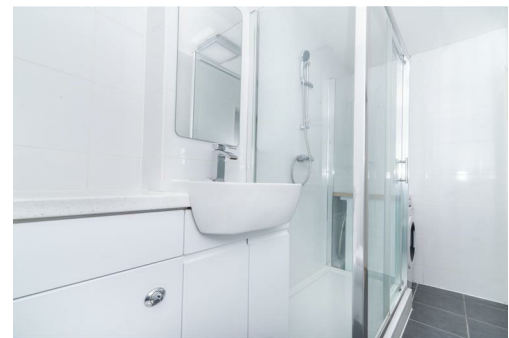

Roman Road, E2 0QN

First Floor

Approx. 31 Sq. meters (333 Sq. feet)

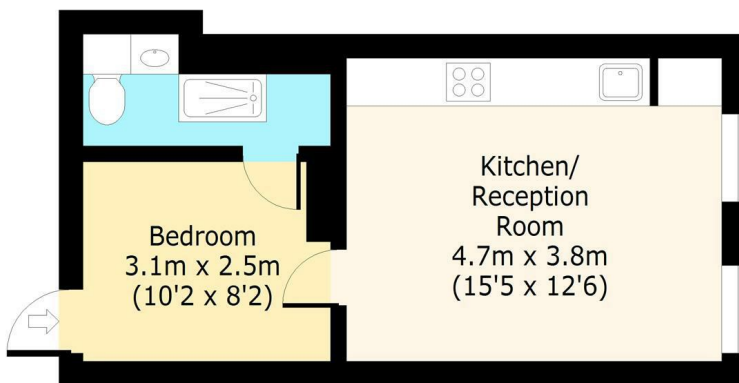

Total area: approx. 31 Sq. meters (333 Sq. feet)
For illustration purposes only - not to scale
www.lpaplus.com

Energy Efficiency Rating		Environmental Impact (CO ₂) Rating	
Current	Potential	Current	Potential
<p>Very energy efficient - lower running costs</p> <p>Very environmentally friendly - lower CO₂ emissions</p>			
<p>(92 plus+) A</p> <p>(81-91) B</p> <p>(69-80) C</p> <p>(55-68) D</p> <p>(39-54) E</p> <p>(21-38) F</p> <p>(1-20) G</p> <p>Not energy efficient - higher running costs</p> <p>Not environmentally friendly - higher CO₂ emissions</p>			
84	85	83	83
England & Wales		England & Wales	
EU Directive 2002/91/EC		EU Directive 2002/91/EC	