



St. Pauls Street South

, Cheltenham, GL50 4AW

Asking Price Of £240,000

- Four Bedroom (One Downstairs)
- Semi-Detached
- Currently Rented To Students
- Downstairs En-Suite To Bedroom Four
- Off Street Parking
- Older Style Garage
- Good Sized Garden
- Family Bathroom

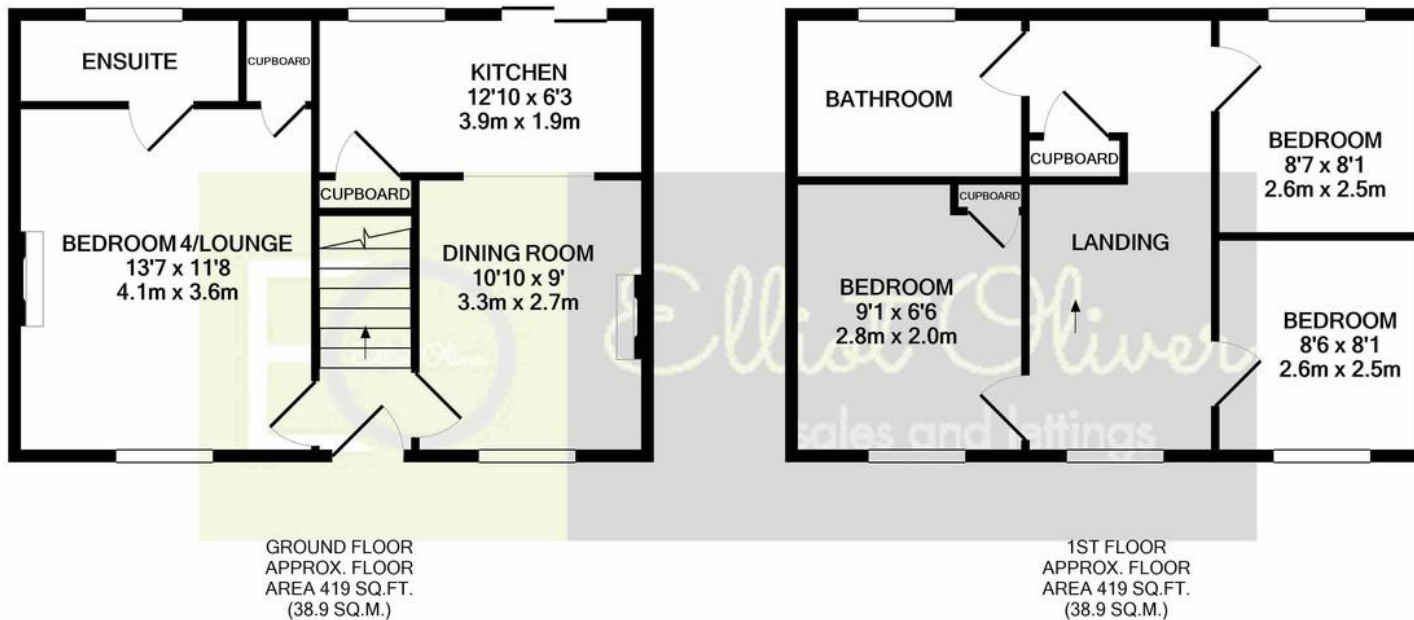

GROUND FLOOR
APPROX. FLOOR
AREA 419 SQ.FT.
(38.9 SQ.M.)

1ST FLOOR
APPROX. FLOOR
AREA 419 SQ.FT.
(38.9 SQ.M.)

TOTAL APPROX. FLOOR AREA 838 SQ.FT. (77.8 SQ.M.)

Whilst every attempt has been made to ensure the accuracy of the floor plan contained here, measurements of doors, windows, rooms and any other items are approximate and no responsibility is taken for any error, omission, or mis-statement. This plan is for illustrative purposes only and should be used as such by any prospective purchaser. The services, systems and appliances shown have not been tested and no guarantee as to their operability or efficiency can be given
Made with Metropix ©2021

COUNCIL TAX BAND

Tax band

TENURE

Freehold

LOCAL AUTHORITY

Cheltenham Borough Council

Energy Efficiency Rating		
	Current	Potential
Very energy efficient - lower running costs		
(92-100) A		
(81-91) B		91
(69-80) C	75	
(55-68) D		
(39-54) E		

OFFICE

101 Promenade, Cheltenham,
Gloucestershire, GL50 1NW

T: 01242 321091

E: info@elliottoliver.co.uk

W: www.elliottoliver.co.uk

Agents Note: Whilst every care has been taken to prepare these sales particulars, they are for guidance purposes only. All measurements are approximate and for general guidance purposes only and whilst every care has been taken to ensure their accuracy, they should not be relied upon and potential buyers are advised to recheck the measurements