

Richardson

CHARTERED SURVEYORS

**Paddock & Orchard
Church Lane, Lyddington
Oakham, LE15 9LN**

FOR SALE

LOT 1 - £65,000, LOT 2 - £20,000



- Sold in Two Lots
- 0.38 Acres Orchard
- By Informal Tender - 23.7.21
- 1.54 Acres Permanent Pasture

Sheep Market House, Stamford, PE9 2RB



www.richardsonestateagents.co.uk

01780 762433

Introduction

Comprising an attractive paddock of permanent pasture along with a small orchard area located in a delightful position in this quiet Rutland village. The property is offered in two lots and is for sale by informal tender, with a tender deadline of 23rd July 2021.

Directions

From Main Street in Lyddington village travel along Church Lane and take the right hand lane where the road forks at the church. Church Lane paddock is located on the right hand side, whilst the orchard is accessed via the pedestrian walkway adjacent the field gate.

Description

Lot 1 Church Lane Paddock - Shown coloured Red

Comprises a single enclosure of permanent pasture extending to approx 1.54 acres. The field is securely fenced for livestock and has a wooden field gate. The brook forming the eastern boundary provides a source of fresh water. The paddock is currently grazed by horses, however, it has in the past been grazed with sheep. The guide price for Lot 1 is £65,000.

Lot 2 The Orchard - Shown coloured Blue

Extends to approx 0.38 acres and provides a tranquil wooded area of broad leaf tree species bordered by the brook. The orchard is currently mowed to provide a network of grass footpaths interspersed with taller grasses and wild flowers. The orchard is accessed via the wooden hand gate to the right hand side of the main gate. The guide price for Lot 2 is £20,000.

Tenure

Church Lane Paddock is currently occupied under a grazing licence which expires on the 31st October 2021. The orchard is offered for sale with the benefit of vacant possession.

Basic Payment Scheme & Environmental Scheme

The land is not registered for the Basic Payment Scheme and is not included within any environmental scheme and is therefore sold free of any management restriction.

Easements, Wayleaves and Rights of Way

The property is sold subject to and with the benefit of all existing wayleaves, easements and rights of way, whether public or private, and any other rights, obligations, easements and quasi easements, whether specifically mentioned or not. Lot 1 has a wooden pole and stay wire.

Sporting, Timber & Mineral Rights

The sporting, mineral and timber rights are included in the freehold sale, to the extent as they are owned.

Services

There are no mains services connected to the land.

Local Authority

The property is located in the administrative boundaries of Rutland County Council.

Historic Designation

The land is not affected or restricted by any Ancient Monument designation.

Health & Safety

Please be as vigilant as possible when making your inspection. Please observe any specific signage of the property. Please adhere to any Government guidelines in respect to Covid-19.

Further Information

For further information please contact Mark Thomas direct line 01780 758009, mobile 07970 817789 or email mthomas@richardsonsurveyors.co.uk

Plans

The plan outlined in these details is for identification purposes only.

Viewings

At any daylight hour, on foot, with a set of these particulars to hand.

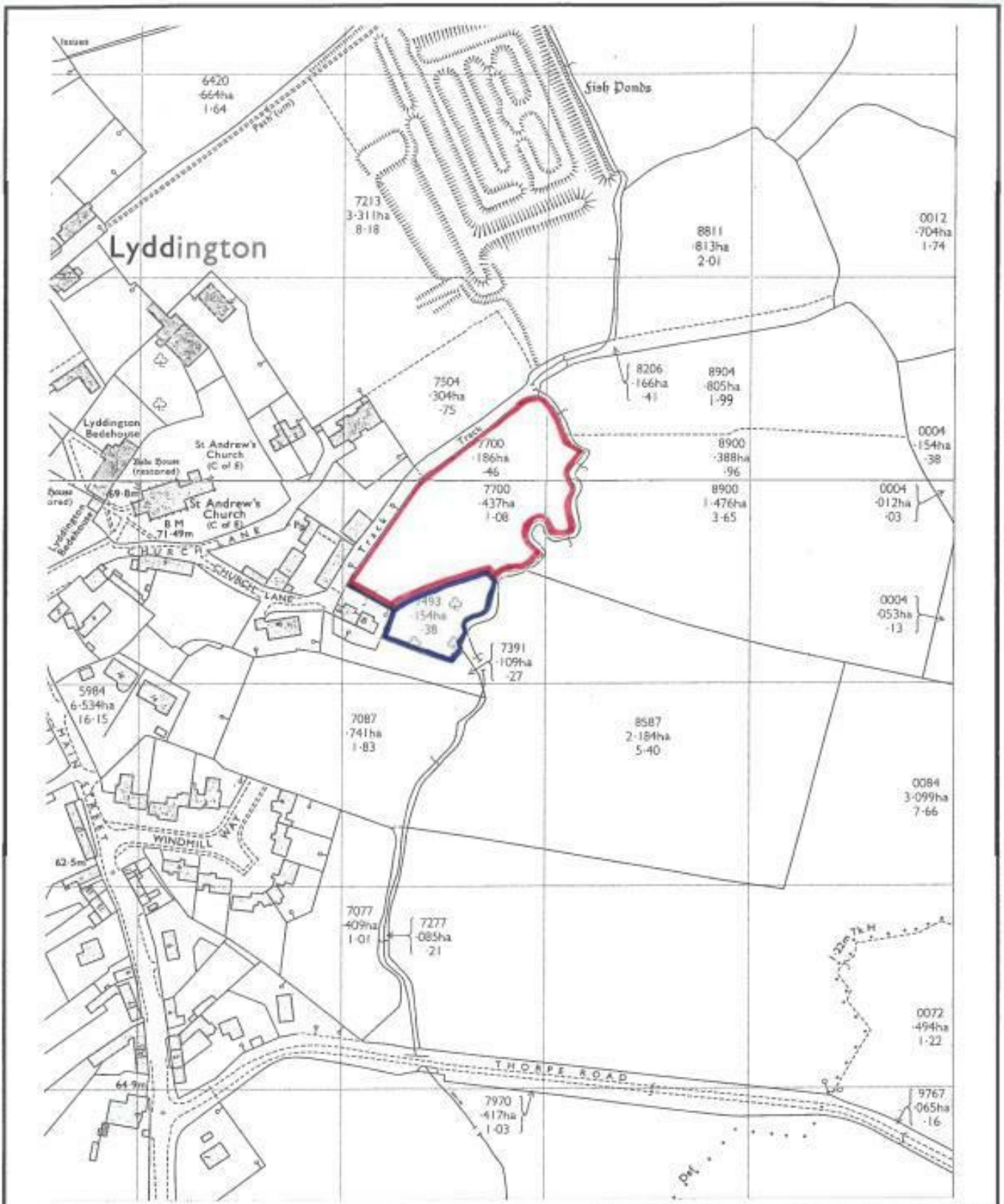

TITLE: Land at Church Lane, Lyddington

SCALE: 1:2500 DATE: June 2021

PLAN REF: A1

This plan is published for convenience only and although it is thought to be correct its accuracy is not guaranteed. Reproduction from the Ordnance Survey Map with the sanction of the controller of H.M. Stationery Office. Crown Copyright reserved. FOR IDENTIFICATION PURPOSES ONLY. ES100003856

Richardson

01780 762433

Sheep Market House, Stamford PE9 2RB



IMPORTANT NOTICE - Richardson for themselves and the Vendors or Lessors of this property whose agents they are given notice that:

1. The particulars are intended to give a fair and substantially correct overall description for the use and the guidance of intending purchasers and do not constitute, nor constitute any part of an offer or contract. Prospective purchasers and lessees should seek their own professional advice.
2. All descriptions, dimensions, reference to condition and necessary permissions for the use and occupation and their details are given in good faith, and are believed to be correct, but any intending purchaser or tenants should not rely on them as statements or representations of fact but must satisfy themselves by inspection or otherwise to the correctness of each or them.
3. No person in the employment of Richardson has the authority to make or give any representation or warranty whatever in relation to this property on behalf of Richardson, nor enter into any contract on behalf of the vendor.
4. No responsibility can be accepted for any expenses incurred by intending purchasers or lessees in inspecting properties which have been sold, let or withdrawn.

MEASUREMENTS AND OTHER INFORMATION - All measurements are approximate. Whilst we endeavour to make our sales details reliable, if there is any point which is of particular importance to you, please contact the agent, who will be pleased to check the information for you, especially if you will be travelling some distance to view the property. Electrical and other appliances mentioned within the sale particulars have not been tested by Richardson, therefore prospective purchasers must satisfy themselves as to their working order. The sale is subject to all rights of support, public and private rights of way, water, light, drainage and other easements, quasi-easements and way leaves, all other rights, whether mentioned in these particulars or not.

MONEY LAUNDERING REGULATIONS - Intending purchasers will be asked to produce identification and proof of financial status when an offer is received. We would ask for your co-operation in order that no delay in agreeing a sale.