



Capital Homes
Estate Agents & Valuers

48 Blake Road, London N11 2AH
£900,000





Available for sale is this three bedroom, 1920's family home that comprises of fantastic living space in abundance. This beautifully presented house displays character throughout and comprises of three large bedrooms, high ceilings, large front reception, well sized fitted kitchen, two fully fitted bathroom's and a huge, stunningly sized through lounge leading to 100 ft garden facing west.

This charming property is situated within close proximity of Bounds Green Tube Station (Piccadilly Line), Alexandra Park School, St Martins of Porres Primary School, Heartlands Secondary & Bounds Green Primary. Additionally, there is renovation potential to extend into the loft under planning consents.

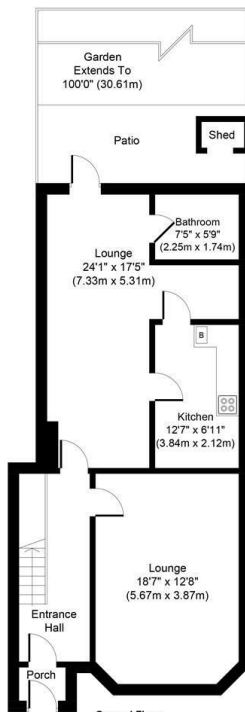

Whilst every attempt has been made to ensure the accuracy of the floor plan contained here, measurements of doors, windows, rooms and any other items are approximate and no responsibility is taken for any error, omission, or mis-statement. This plan is for illustrative purposes only and should be used as such by any prospective purchaser or tenant. The services, systems and appliances shown have not been tested and no guarantee is given as to their operability or efficiency can be given.
Copyright V360 Ltd 2021 | www.houseviz.com

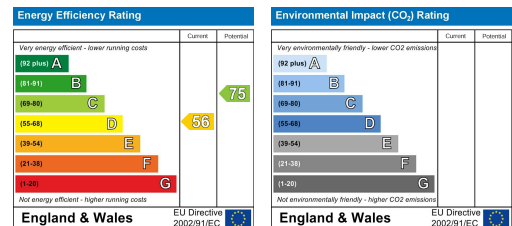

1 Turnpike Lane
London
N8 0EP

0208 342 5555
info@capitalhomestates.co.uk
www.capitalhomestates.co.uk

Agents Note: Whilst every care has been taken to prepare these particulars, they are for guidance purposes only. All measurements are approximate are for general guidance purposes only and whilst every care has been taken to ensure their accuracy, they should not be relied upon and potential buyers/tenants are advised to recheck the measurements