



4 Salamanca Tower, Nine Elms
London SE1

GARTONJONES.COM



4 Salamanca Tower, Nine Elms London, SE1

£380 Per Week

A bright 1 double bedroom apartment on the 15th floor of this modern development with views of Parliament and Big Ben. Benefits include an open plan reception room with floor to ceiling windows, a modern integrated kitchen, excellent storage and bathroom. Salamanca Place is within walking distance of the shops, restaurants and attractions of London's South Bank and the West End. The rail/tube links of Vauxhall are within easy reach and there is a frequent bus service accessing most of London on the doorstep. Offered furnished and available soon.

- 423.00 sq.ft
- 1 Double Bedroom
- Bathroom
- Open Plan Reception Room
- Modern Kitchen
- Juliette Style Balcony
- North West Aspect
- Lift
- Close to Vauxhall Tube/Rail Links
- On-Site Convenience Store

GARTON JONES.COM

9 Albert
Embankment
London
SE1 7SP

Lettings:
+44 (0) 20 7735 1888
nineelms@gartonjones.com
www.gartonjones.com



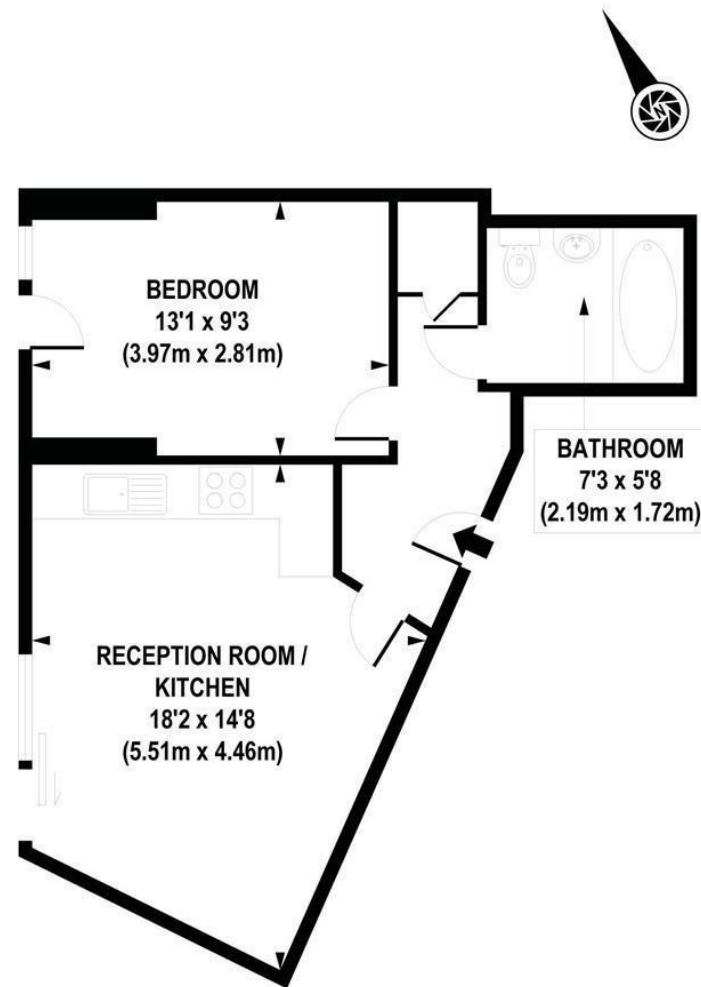

APPROXIMATE GROSS INTERNAL AREA 423 sq. ft / 39.28 sq. m

