

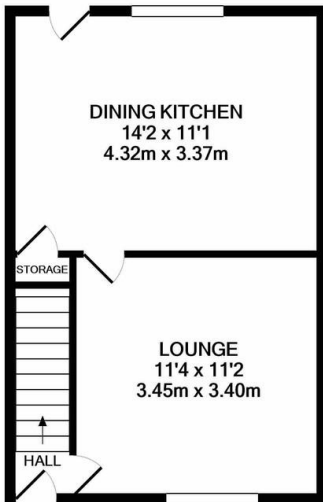

# Property Summary

A well presented and well proportioned mid terrace property for sale in South Wigston. The accommodation comprises entrance hall, lounge, dining kitchen, two double bedrooms, bathroom, garden to the rear and hard standing to the front of the property. This house is a real must see so call Phillips George to book your viewing today!



GROUND FLOOR  
APPROX. FLOOR  
AREA 314 SQ.FT.  
(29.2 SQ.M.)

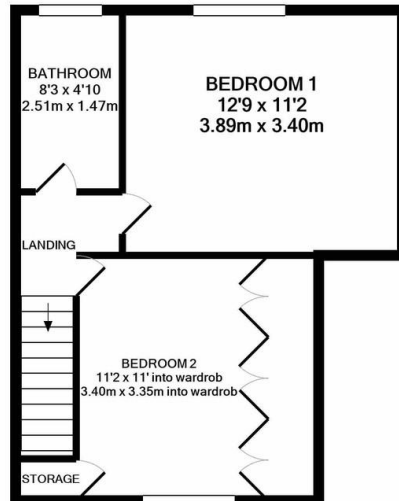

1ST FLOOR  
APPROX. FLOOR  
AREA 350 SQ.FT.  
(32.5 SQ.M.)

FLOOR PLAN BY PHILLIPS GEORGE  
TOTAL APPROX. FLOOR AREA 664 SQ.FT. (61.7 SQ.M.)

Whilst every attempt has been made to ensure the accuracy of the floor plan contained here, measurements of doors, windows, rooms and any other items are approximate and no responsibility is taken for any error, omission, or mis-statement. This plan is for illustrative purposes only and should be used as such by any prospective purchaser. The services, systems and appliances shown have not been tested and no guarantee as to their operability or efficiency can be given  
Made with Metropix ©2021

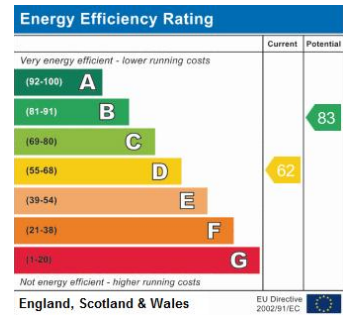

- Mid Terrace
- Two Bedrooms
- Modern Bathroom
- Hard Standing To Front Of Property
- Quiet Cul-De-Sac
- Landscaped Rear Garden
- Kitchen Diner
- Both Bedrooms Double

phillips george | sales & lettings

Agents Note: Whilst every care has been taken to prepare these sales particulars, they are for guidance purposes only. All measurements are approximate and for general guidance purposes only and whilst every care has been taken to ensure their accuracy, they should not be relied upon and potential buyers are advised to recheck the measurements

46 Long Street, Wigston, Leicestershire, LE18 2AH

info@phillipsgeorge.co.uk  
0116 216 8178

