



house.

Twydale Cottage The Street Ewhurst Cranleigh Surrey GU6 7QA

Enjoying a village location in the Surrey Hills, an Area of Outstanding Natural Beauty, a character family home offered in immaculate order throughout

- Entrance hall
- Sitting room and family room
- Study
- Kitchen / dining room
- Utility room and cloakroom
- Master bedroom with en suite shower room
- 3 further bedrooms and family bathroom
- Gardens and garden store
- Driveway parking
- EPC: D

h.

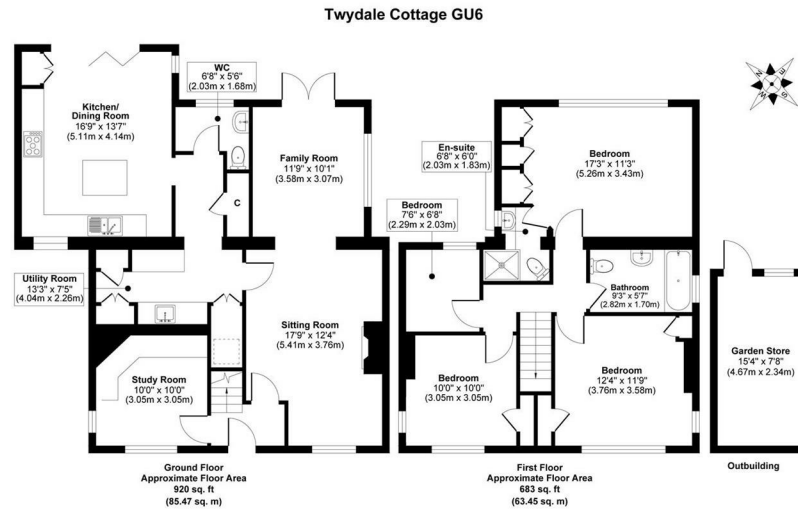

Approx. Gross Internal Floor Area 1603 sq. ft / 148.92 sq. m
Illustration for identification purposes only; measurements are approximate, not to scale.



Approximate total gross internal area: House 1603 sq ft / 148.92 sq m.

Services: Mains water, electricity and gas. Gas-fired central heating.

Local authority: Waverley Borough Council. Tel: 01483 523333.

Viewing: Strictly by appointment. Tel: 01483 266721.

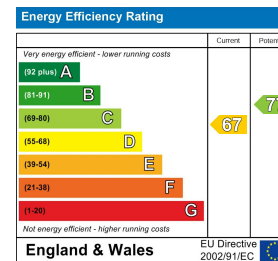

www.housepartnership.co.uk



Importance notice: house, their clients and any joint agent give notice that they are not authorised to make or give any representations or warranties in relation to the property either here or elsewhere, either on their own behalf of the client or otherwise. They assume no responsibility for any statement that may be made in these particulars. These particulars do not form part of any offer or contract and must not be relied upon as statement or representation of fact. Any areas, measurement or distance are approximate. The text, photographs and plans are for guidance only and are not necessarily comprehensive. It should not be assumed that the property has all necessary planning, building regulations or other consent and house, have not tested any services, equipment or facilities. Purchasers must satisfy themselves by inspecting or otherwise.

