



- A Two Bedroom Mid Terrace Home
- Lounge, Kitchen With Dining Space
- Two Bedrooms, Three Piece Bathroom
- Enclosed Rear Yard, NO CHAIN

Cameron Avenue, Blackpool, FY3

Offers In Excess Of £70,000

THE IDEAL FIRST TIME BUYERS HOME OR INVESTMENT - IN THE HEART OF LAYTON WITH EVERYTHING YOU NEED ON YOUR DOORSTEP - LOUNGE - KITCHEN WITH DINING SPACE - TWO BEDROOMS - THREE PIECE BATHROOM - ENCLOSED REAR YARD - DOUBLE GLAZED - CENTRAL HEATING - NO CHAIN - VIEWINGS RECOMMENDED



Property Description

HALL

Door into;

LOUNGE

13' 2" x 13' 10" (4.02m x 4.22m) Double glazed window to front, fitted carpet, radiator and wall mounted electric fire.

KITCHEN

10' 11" x 11' 11" (3.34m x 3.64m) A range of wall and base units with complimentary work surfaces over, inset stainless steel sink unit with mixer tap and drainer, electric hob with extractor above and oven below, radiator, plumbing for washing machine and space for fridge freezer. Vinyl flooring and double glazed window and door to rear. Stairs to first floor.

LANDING

Fitted carpet and access to all rooms.

BEDROOM ONE

12' 7" x 12' 0" (3.85m x 3.68m) Double glazed window to front, fitted carpet and radiator.

BEDROOM TWO

10' 4" x 6' 6" (3.15m x 2.00m) Double glazed window to rear, fitted carpet and radiator.

BATHROOM

A three piece suite comprising of low flush WC, pedestal wash hand basin and panelled bath. Laminate flooring, radiator and double glazed opaque window to rear.

EXTERIOR

Low maintenance and enclosed rear yard.





Ground Floor

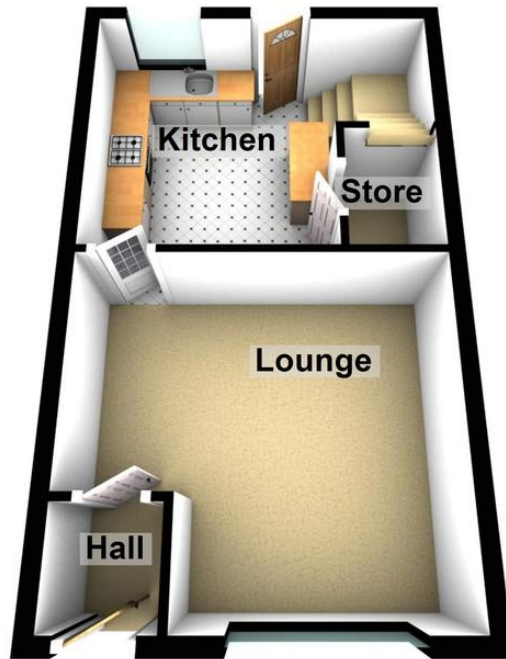

First Floor

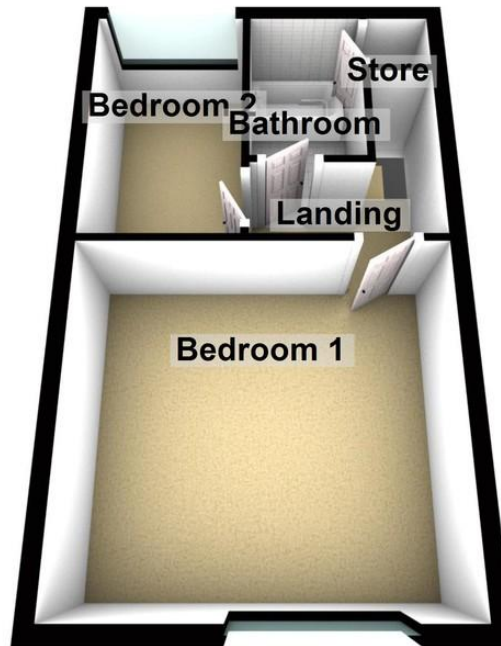

Awaiting EPC

29 Whitegate Drive, Blackpool,
Lancashire, FY3 9AA

www.romanjamesestates.co.uk
01253 978888
info@romanjamesestates.co.uk

Agents Note: Whilst every care has been taken to prepare these sales particulars, they are for guidance purposes only. All measurements are approximate and are for general guidance purposes only and whilst every care has been taken to ensure their accuracy, they should not be relied upon and potential buyers are advised to recheck the measurements