

24 Market Place, Bolsover, Chesterfield, S44 6PN  
01246 822 138  
enquiries@wilsonstateagents.co.uk  
www.wilsonstateagents.co.uk



11 Bridge Street  
Chesterfield, Derbyshire S40 2EQ

**OFFERS IN THE REGION OF £124,950**

**\*NO CHAIN\*** Lovely little starter home / investment opportunity benefiting from a good sized enclosed rear garden. Enjoying a popular location with easy access to the town centre and with good links to the M1. The accommodation is well presented and spacious comprising living room, breakfast kitchen, a double bedroom, single bedroom and bathroom to the first floor with attic room located on the second floor. Set back from the main road and close to a bus route this property would suit first time buyers and /or investor alike.

## 11 BRIDGE STREET, CHESTERFIELD, DERBYSHIRE S40 2EQ



**Ground Floor**

Approx. 31.6 sq. metres (339.8 sq. feet)

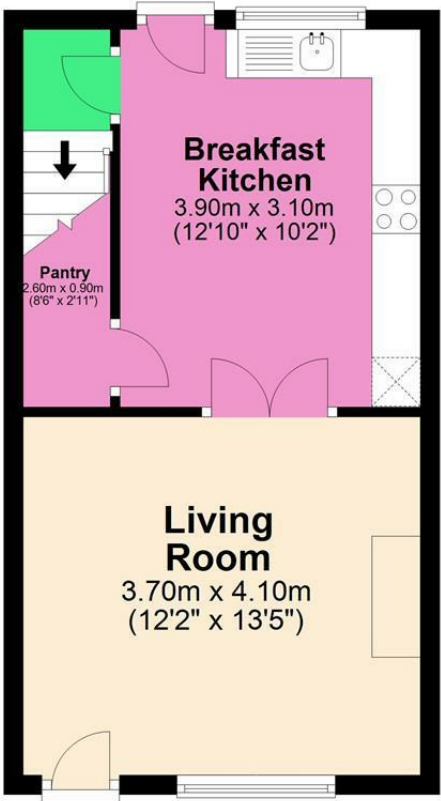

**First Floor**

Approx. 30.8 sq. metres (331.6 sq. feet)

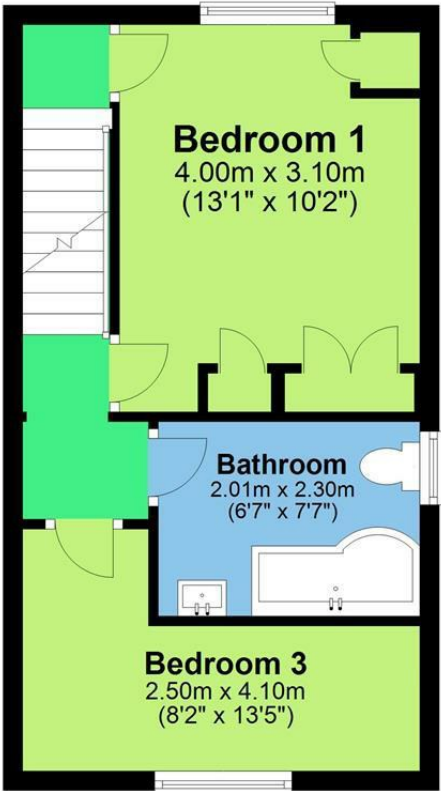

**Second Floor**

Approx. 27.1 sq. metres (291.7 sq. feet)



Total area: approx. 89.5 sq. metres (963.1 sq. feet)  
**11 Bridge Street**

