



Windsock Close, Surrey Quays

Asking Price £260,000 Leasehold - Share of Freehold

OLIVER  JACQUES  
EST. 1986





## Windsock Close, Surrey Quays

Making a great first home or pied a terre, this entry level property on the edge of South Dock Marina offers a great opportunity to get a foot on the Docklands' housing ladder. Offered for sale with a share of the development's freehold, this naturally bright property spans in excess of 30sqm and enjoys an 18sqm studio room allowing space for a sleeping and living area, with separate kitchen and bathroom. The interiors require some cosmetic redecoration and the property is crying out for someone to make their own mark and turn this into a beautiful home. A rare find at this price point in a private development, this property is bound to be popular in an increasingly popular corner of Surrey Quays.

- Second Floor Studio
- Direct Views Over Marina
- Residents' Parking
- Fully Double Glazed
- Entry Level First Home
- Safe and Secure Pied a Terre

**South East London**  
020 7231 5050

Email [southeast@o-j.co.uk](mailto:southeast@o-j.co.uk)

229-231 Lower Road, London, SE16 2LW

web [www.o-j.co.uk](http://www.o-j.co.uk)

Every care has been taken with the preparation of this brochure but it is for general guidance only and complete accuracy cannot be guaranteed. If there is any point, which is of importance professional verification should be sought. This brochure does not constitute a contract or part of a contract. We are not qualified to verify tenure of property. Prospective purchasers should seek clarification from their solicitor or verify the tenure of this property for themselves by visiting [www.gov.uk/government/organisations/land-registry](http://www.gov.uk/government/organisations/land-registry). The mention of any appliances, fixtures or fittings does not imply they are in full working order. Photographs are reproduced for general information and it cannot be inferred that any item shown is included in the sale. All dimensions are approximate. Walking times are taken from Google Maps and measured from the centre of the postcode, which may differ from the individual property. We always refer prospective buyers to our panelled conveyancers and Chancery Mortgage Services Ltd. It is your decision whether to use them. Should you decide to do so you should know that we could receive a referral fee from them for recommending them to you.

**Windsock Close, London, SE16**

Approximate Area = 328 sq ft / 30.5 sq m

For identification only - Not to scale

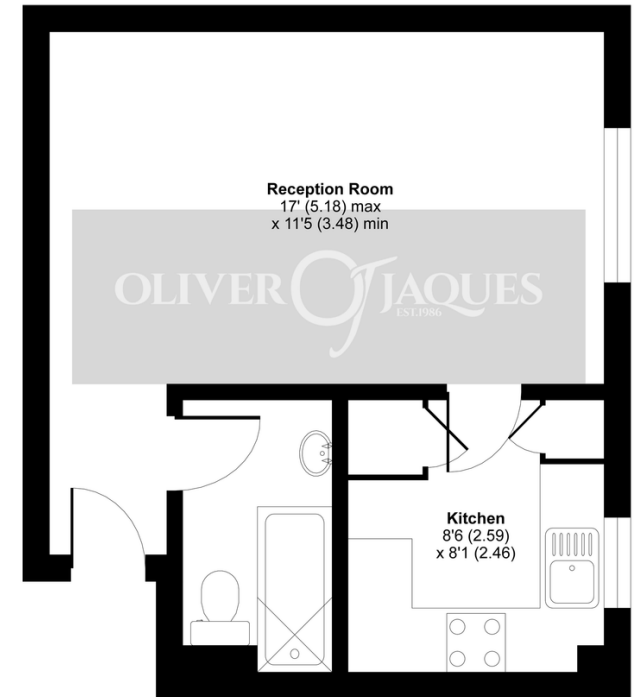

**RICS Certified Property Measurer** Floor plan produced in accordance with RICS Property Measurement Standards incorporating International Property Measurement Standards (IPMS2 Residential). © richrecom 2021. Produced for Oliver Jacques - REF: 720182

Energy Efficiency Rating		Current	Potential
Very energy efficient - lower running costs			
(92-100)	<b>A</b>		
(81-91)	<b>B</b>		
(69-80)	<b>C</b>	7.2	7.9
(55-68)	<b>D</b>		
(39-54)	<b>E</b>		
(21-38)	<b>F</b>		
(1-20)	<b>G</b>		
Not energy efficient - higher running costs			
England, Scotland & Wales		EU Directive 2002/91/EC	