



- Spacious One Bedroom Ground Floor Apartment
- Lounge With Gorgeous Views Over Looking Gardens & Fitted Kitchen
- Three Piece Wet Room
- A allocated Parking & Communal Gardens

## Homefylde House, Whitegate Drive, Blackpool, FY3

£59,950

WELL PRESENTED ONE BEDROOM GROUND FLOOR APARTMENT IN EXCELLENT LOCATION - GOOD SIZED LOUNGE - KITCHEN - MASTER BEDROOM WITH FITTED WARDROBES - THREE PIECE WET ROOM - ALLOCATED PARKING - COMMUNAL GARDENS - NO CHAIN DELAY - VIEWINGS HIGHLY RECOMMENDED





## Property Description

### COMMUNAL ENTRANCE

Intercom security system, communal areas are fully carpeted.

### LOUNGE/DINER

15' 0" x 10' 6" (4.58m x 3.22m) Double glazed French patio doors to front over looking communal gardens, storage heater, fitted carpets. Open planned to:-

### KITCHEN

7' 3" x 5' 7" (2.21m x 1.71m) Fitted with a matching range of base and eye level units with worktop space over and drawers, stainless steel sink unit with single drainer and mixer tap, part tiled walls, space for oven and fridge/freezer, plumbed for automatic washing machine.

### MASTER BEDROOM

11' 11" x 8' 9" (3.64m x 2.69m) Double glazed window to front, storage heater, fitted carpets & fitted wardrobes.

### WET ROOM

6' 9" x 4' 11" (2.07m x 1.51m) Fitted with a three piece suite comprising walk in shower, pedestal wash hand basin and low-level WC, tiled surround, heated towel rail and extractor fan.

### ADDITIONAL INFORMATION

Exclusively for over 60's this retirement property is set in purpose built development offering all the benefits of retirement living. Available on a 'Lifetime' long term assured tenancy for your added peace of mind.

### EXTERNAL

To the front of the property there are beautiful well maintained gardens and a communal entrance with a intercom. There is allocated parking to the rear.







## Ground Floor

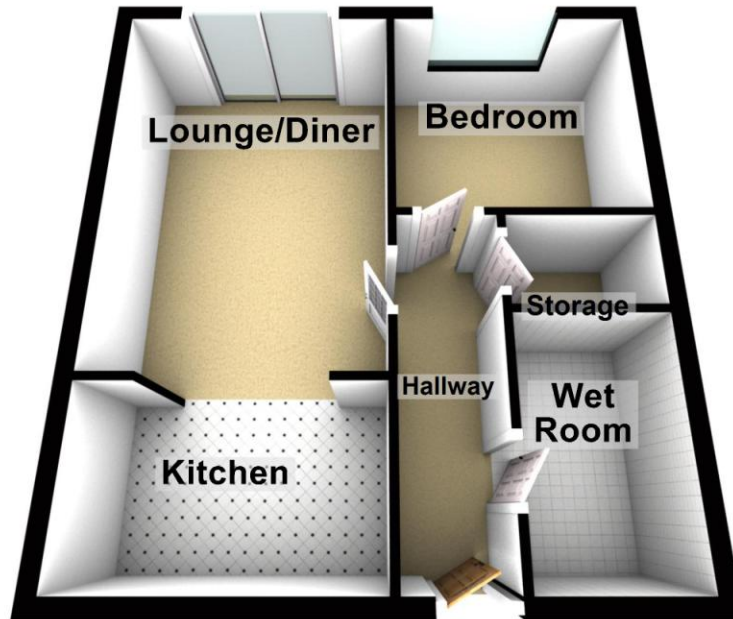

EPC TO FOLLOW

29 Whitegate Drive, Blackpool,  
Lancashire, FY3 9AA

[www.romanjamesestates.co.uk](http://www.romanjamesestates.co.uk)  
01253 978888  
[info@romanjamesestates.co.uk](mailto:info@romanjamesestates.co.uk)

Agents Note: Whilst every care has been taken to prepare these sales particulars, they are for guidance purposes only. All measurements are approximate and are for general guidance purposes only and whilst every care has been taken to ensure their accuracy, they should not be relied upon and potential buyers are advised to recheck the measurements