

Requiring modernisation is this charming double bayed mid terraced house

CHURCHILL
estates



Henniker Gardens, East Ham, E6 3HS

£375,000 Freehold



To view call **0208 503 6060**
email walthamstow@churchill-estates.co.uk





Requiring modernisation is this charming double bayed mid terraced house situated on a popular residential turning within a couple of minutes' walk of Central Park.

Retaining some of its original features, this family home requires upgrading and refurbishment.

The accommodation comprises of two bedrooms and bathroom/wc to the first floor whilst to the ground floor there are two reception rooms, and a galley kitchen, in addition there is a cellar beneath the entrance hall. Externally there is a good size garden with gardeners wc

Offered with no onward chain, viewing is advised.





BASEMENT
58 sq.ft. (5.4 sq.m.) approx.

GROUND FLOOR
398 sq.ft. (37.0 sq.m.) approx.

1ST FLOOR
352 sq.ft. (33.7 sq.m.) approx.

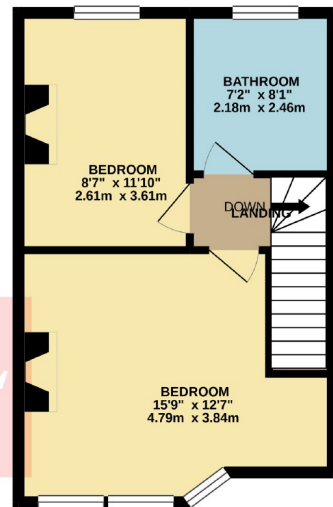
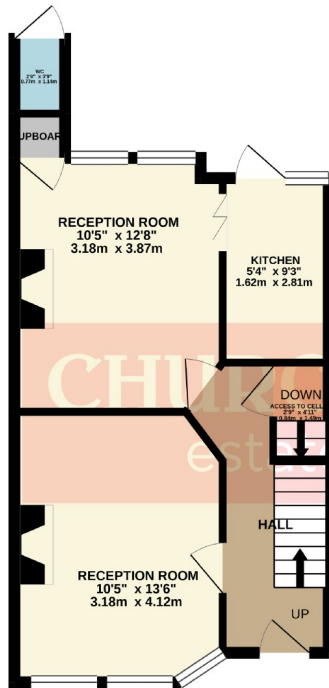
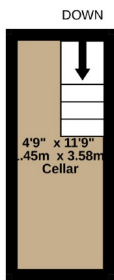

TOTAL FLOOR AREA : 819 sq.ft. (76.1 sq.m.) approx.

Whilst every attempt has been made to ensure the accuracy of the floorplan contained here, measurements of doors, windows, rooms and any other items are approximate and no responsibility is taken for any error, omission or mis-statement. This plan is for illustrative purposes only and should be used as such by any prospective purchaser. The services, systems and appliances shown have not been tested and no guarantee as to their operability or efficiency can be given.
Made with Metropax ©2021

The Agent has not tested any apparatus, equipment, fixtures and fittings or services and so cannot verify that they are in working order or fit for the purpose. A buyer is advised to obtain verification from their solicitor or surveyor. References to the tenure of a property are based on information supplied by the seller. The agent has not had the sight of the title documents. A buyer is advised to obtain verification from their solicitors.



To view call **0208 503 6060**
email walthamstow@churchill-estates.co.uk