



 **2**  
Bedrooms

 **1**  
Bathroom

**4 Queen's Rd, Wimbledon, London SW19 8YE, UK |**  
**Wimbledon@rentalsandsales.co.uk**

**02089446212**





**\*Weydown Close, Southfields SW19\***

We are proud to offer to the market this two-bedroom flat. The property is located on the first floor of this popular purpose building. There are two good double bedrooms, a family bathroom with separate WC and a modern separate kitchen. The property has a bright living room and a balcony. This accommodation is coming with free permit parking.

We strongly advise that any persons interested watch the video tour. This allows you to walk around the house as if you are there!

<https://view.ricohtours.com/33b24bd5-d926-44e0-822a-d99296a0ecea>

Weydown Close is located just 0.4 miles from Southfields Tube Station and Southfields Village. All England Wimbledon Lawn Tennis is just 0.5 miles from this property and Wimbledon Common is 0.5 miles from the flat.

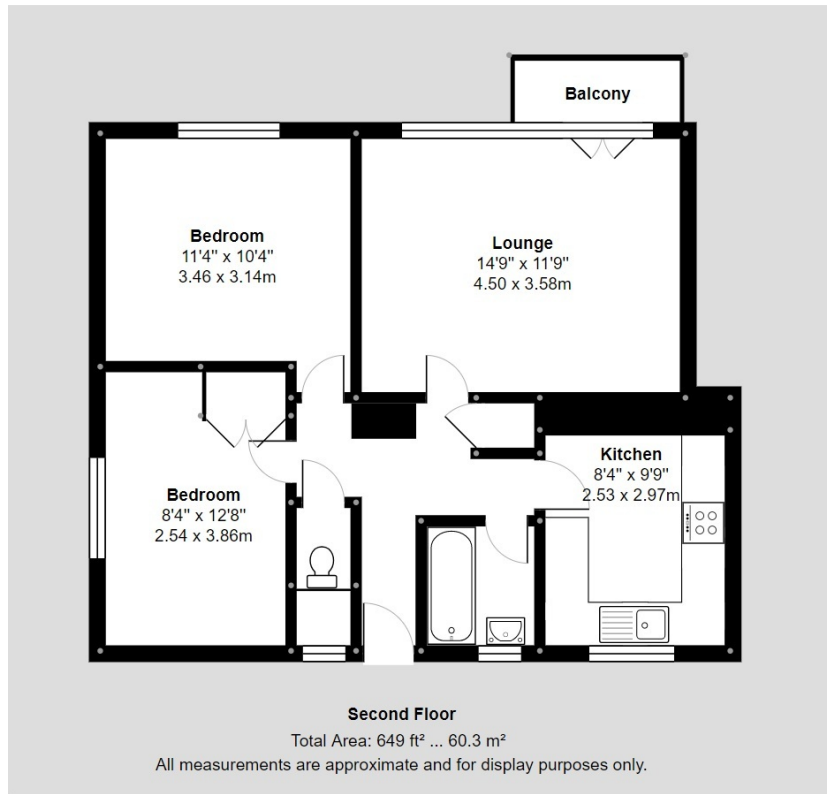

Score	Energy rating	Current	Potential
92+	A		
81-91	B		82   B
69-80	C	72   c	
55-68	D		
39-54	E		
21-38	F		
1-20	G		

