

**SOLD STC**



**Turnpike Link, Park Hill, East Croydon**

**3 Bedrooms, 1 Bathroom, Ground Floor Maisonette**

**Asking Price Of £385,000**

**MARTIN&CO**



## Turnpike Link, Park Hill, East Croydon

3 Bedrooms, 1 Bathroom

Asking Price Of £385,000

- Spacious Maisonette
- Sought-After Park Hill
- 2/3 Bedrooms
- 1/2 Reception Rooms
- Close to East Croydon Station

Don't miss this superb maisonette, cleverly remodelled to provide flexible accommodation, in a lovely leafy Park Hill location overlooking a communal garden and conveniently located just 5 minutes from East Croydon Station.

With its own private entrance, the property affords an entrance hall, a spacious open-plan reception room with modern fitted kitchen area leading off and incorporating a dishwasher and gas hob, double doors lead from the reception room to a another room which could be used as either a double bedroom or a dining room if more living space is a preference, there is another double bedroom with built in wardrobes, a very useable third bedroom, and a beautifully finished bathroom/wc. The property also benefits from gas heating to radiators, double glazing and a there is a tremendous amount of storage. For those with a car the property comes with a garage en-bloc with parking in front.

The Tramlink stop at Lebanon Road is just moments away, whilst the town centre, Boxpark and the newly refurbished Fairfield Halls are all within easy reach and there are Sainsbury's and Waitrose stores also close at hand on George Street.

Available with no onward chain, this is the perfect property for commuting professionals or would make an excellent letting investment in our opinion - CALL US NOW FOR AN APPOINTMENT TO VIEW!









%epcGraph\_c\_1\_441%



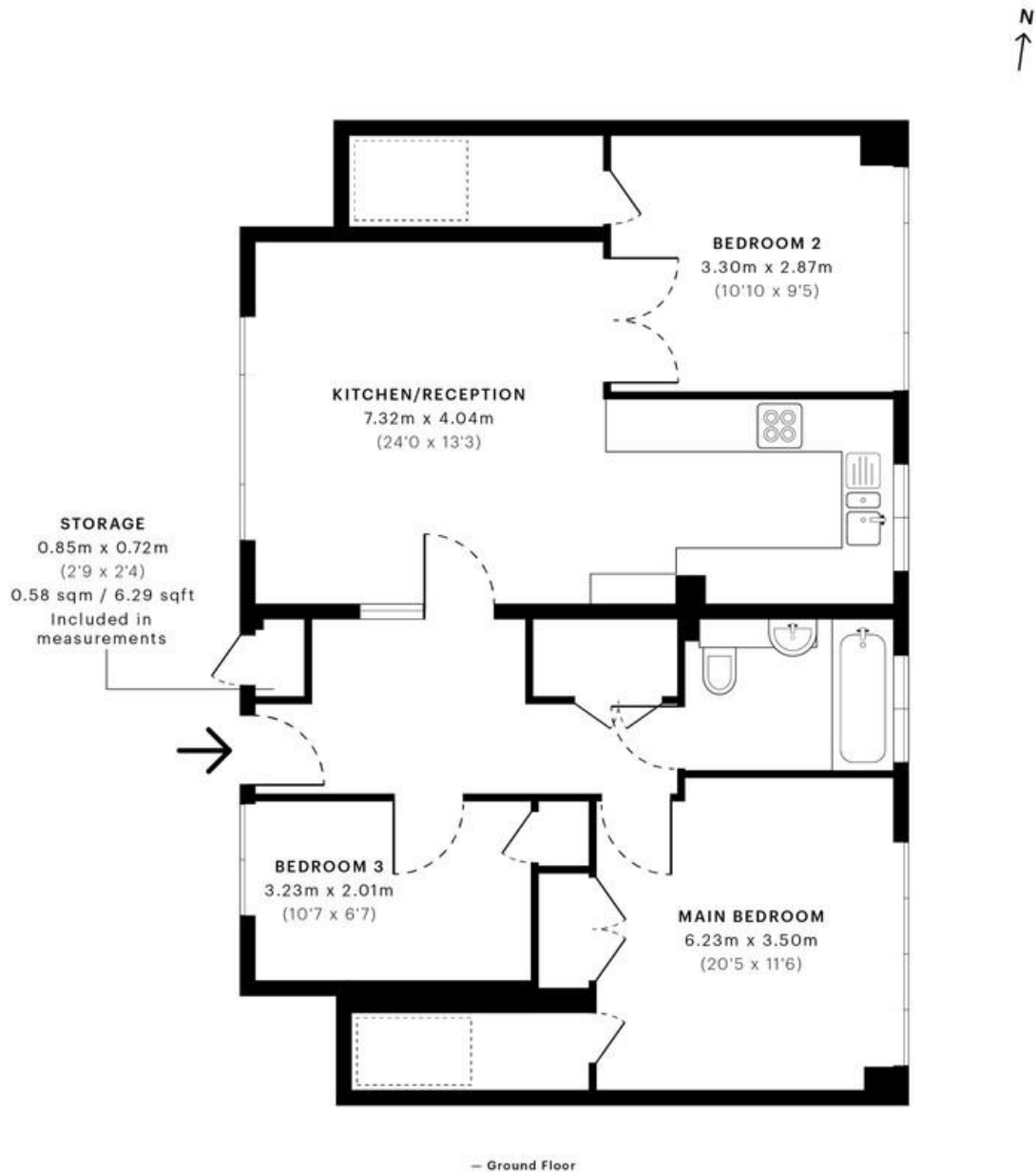

## Martin & Co Croydon

145 Brighton Road • South Croydon • CR2 6EF  
T: 0208 688 8565 • E: croydon@martinco.com

**0208 688 8565**  
<http://www.martinco.com>

**MARTIN&CO**

**Accuracy:** References to the Tenure of a Property are based on information supplied by the Seller. The Agent has not had sight of the title documents. A Buyer is advised to obtain verification from their Solicitor. Items shown in photographs including but not limited to carpets, fixtures and fittings are not included unless specifically mentioned within the sales particulars. They may however be available by separate negotiation. Buyers must check the availability of any property and make an appointment to view before embarking on any journey to see a property. No person in the employment of the agent has any authority to make any representation about the property, and accordingly any information given is entirely without responsibility on the part of the agents, sellers(s) or lessors(s). Any property particulars are not an offer or contract, nor for part of one. **Sonic / laser Tape:** Measurements taken using a sonic / laser tape measure may be subject to a small margin of error. **All Measurements:** All Measurements are Approximate. **Services Not tested:** The Agent has not tested any apparatus, equipment, fixtures and fittings or services and so cannot verify that they are in working order or fit for the purpose. A Buyer is advised to obtain verification from their Solicitor or Surveyor. **Mortgage & Financial Advice:** The Martin & Co mortgage service is provided by London & Country Mortgages the UK's largest Independent Fee-Free mortgage broker of Beazer House, Lower Bristol Road, Bath, BA2 3BA. Authorised and regulated by the Financial Conduct Authority. Their FCA number is 143002. **YOUR HOME IS AT RISK IF YOU DO NOT KEEP UP REPAYMENTS ON A MORTGAGE OR OTHER LOANS SECURED ON IT.** Full written quotation available on request. A suitable life policy may be required. Loans subject to status. Minimum age 18. If you are making a cash offer, we shall require written confirmation of the source and availability of your funds in order that our client may make an informed decision.