



we are
morfittsmith

**Middlewood Lodge,
Middlewood Rise,
Sheffield,
S6 1UR**



Within a stunning redevelopment of a gorgeous Victorian structure, you find a beautiful modern apartment: Middlewood Lodge.

With broad rooms, high ceilings, stunning views and all the modern trimmings, it would be hard not to fall in love with this elegant home.





Time to explore.

As the name might suggest, this historic apartment complex sits in the wonderful community of Middlewood. There are a great deal of things that recommend this area, with easy access to the variety of amenities Middlewood and Hillsborough have to offer. It boasts excellent connections, with SuperTram and bus links across the city and the practical Middlewood Park & Ride. Middlewood Lodge enjoys all this convenience and more from an exceptionally picturesque locale. There are stunning lawned grounds perfect for any outdoor activity, and a coded gate to ensure your security. There is allocated residential parking and even visitors parking available.

Step inside your new home.

The glorious period exterior of Middlewood Lodge discloses nothing of the sleek contemporary renovation inside. Once the administration building to the local hospital, known locally as The Clocktower, it brings with it the broad grounds and rich stylings of its era. The apartment opens into the tall hallway with practical utility storage. To the left is the broad open-plan living space with grand ceilings, tall windows, and space for anything life can throw at you. There is room to dine, relax, entertain, and cook all with views over the beautiful front lawns of the lodge. Down the hallway is bedroom two a particularly smart double bedroom with storage, and the full family bathroom. At the other end of the hall is the spectacular first bedroom with dual aspect windows over the corner of the building. It enjoys its own en suite shower room as well as more fitted storage. This may be one of the most impressive apartments in the entire building and certainly one that will capture your imagination.











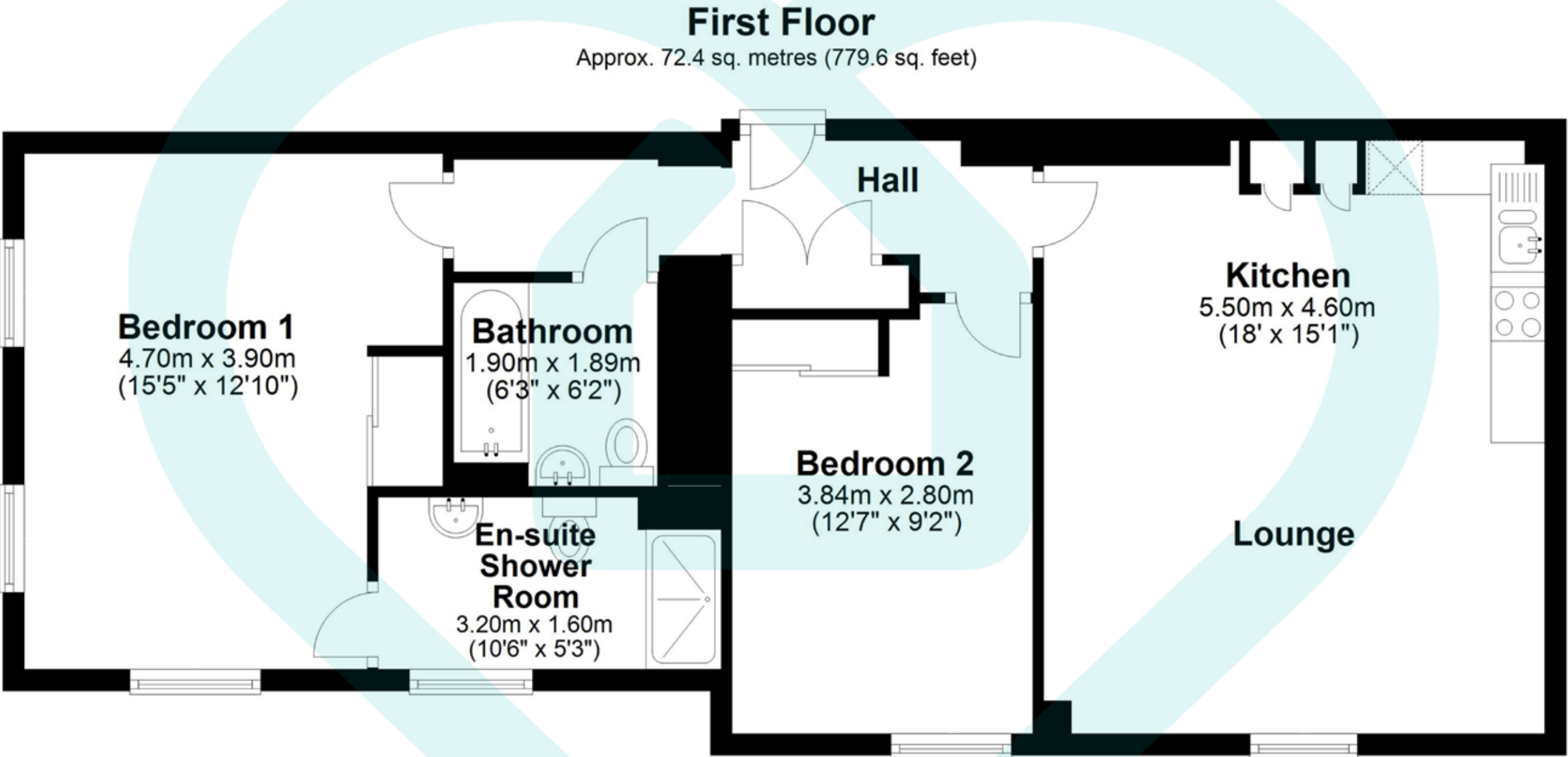

Total area: approx. 72.4 sq. metres (779.6 sq. feet)

Score	Energy rating	Current	Potential
92+	A	72 c	79 c
81-91	B		
69-80	C		
55-68	D		
39-54	E		
21-38	F		
1-20	G		

This floor plan is for illustrative purposes only. All measurements and layouts are approximations and do not necessarily capture the precise specifications of the property. No responsibility is taken for any error, omission, or misstatement.
We always recommend viewing in person to confirm the exact floor



IMPORTANT: we would like to inform prospective purchasers that these sales particulars have been prepared as a general guide only, A detailed survey has not been carried out, nor the services, appliances and fittings tested. Room sizes should not be relied upon for furnishing purposes and are approximate. If floor plans are included, they are for guidance only and illustration purposes only and may not be to scale. If there are any important matters likely to affect your decision to buy, please contact us before viewing the property.



The MorfittSmith Building,
67 Middlewood Road,
Sheffield, S6 4GX



0114 232 1764



www.morfittsmith.co.uk



sales@morfittsmith.co.uk



lettings@morfittsmith.co.uk



newhomes@morfittsmith.co.uk



@morfittsmith



@morfittsmith



MorfittSmith Estate & Letting Agent



morfittsmith



sales | lettings | new homes
