



Wardour Street, Soho, W1F
£625 pw

> 1 Bedroom > 1 Bathroom > Furnished

TAVISTOCKBOW
RESIDENTIAL



- > One bedroom
- > One shower room
- > First floor
- > Wooden floors throughout
- > Open plan kitchen kitchen/reception room
- > Furnished
- > Short walk to Chinatown
- > Short walk to Kingly Court
- > Short walk to Leicester Square and Tottenham Court Road stations
- > Available mid August

A well presented one bedroom apartment to rent in the heart of Soho. Situated on the first floor, this spacious apartment offer a large open plan kitchen and living space with a modern kitchen. There is a double bedroom to the rear of the property and a well appointed shower room. The property is furnished to a high standard

and is available mid August, 1 to 3 year contract, straight or with a minimum 6 months mutual break clause as negotiated.

It is ideally located between Leicester Square and Tottenham Court Road stations, and is a short walk to Carnaby Street and central Covent Garden.

Council tax band G.





WHAT WE LOVE

- Modern finish
- Lots of natural light
- Short walk to the restaurants of Kingly Court
- Secondary glazing
- Furnished to a high standard.

WHAT YOU NEED TO KNOW

- First floor walk up
- Wooden floors throughout
- Closest tube is Leicester Square
- Modern kitchen appliances
- Grade I listed (EPC exempt)



Wardour Street, W1

Approximate Gross Internal Area 41 sq m / 441 sq ft

First Floor

1 Kitchen /
Reception Room
6.39 x 4.30M
21'0" x 14'1"

2 Bedroom
4.21 x 2.49M
13'10" x 8'2"

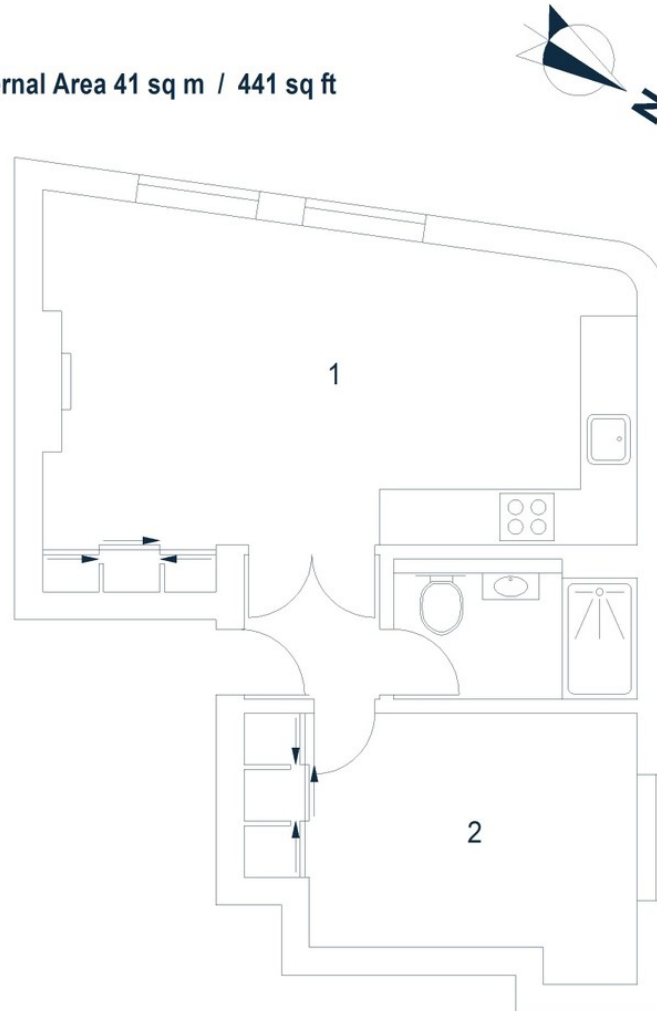

Floor Plan produced for Tavistock Bow by Mays Floorplans © . Tel 020 3397 4594
Illustration for identification purposes only, not to scale.

About Us

Tavistock Bow is an independent residential agency based in Covent Garden. We are niche, boutique, creative, knowledgeable, professional and approachable. We love what we do and that's why we do it.

Contact Us

- a.** 21 New Row, Covent Garden,
- t.** WC2N 4LE
- e.** 020 7477 2177
- w.** hello@tavistockbow.com
tavistockbow.com

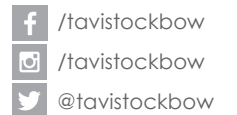

TAVISTOCKBOW
RESIDENTIAL