



1 Nancy Road

Portsmouth, , PO1 5DF

1 Bedroom Apartment

Asking Price Of

£105,000

Property Features

- TENANT IN SITU
- INVESTMENT OPPORTUNITY
- CLOSE TO SHOPS
- CLOSE TO FRATTON TRAIN STATION
- OPEN PLAN KITCHEN LOUNGE
- ONE BEDROOM
- ELECTRIC HEATING
-
-
-

Full Description

HALLWAY

BEDROOM	3.30m x 2.80m
KITCHEN LOUNGE	4.90m x 4.40m
BATHROOM	2.50m x 1.70m

LOUNGE

This good sized lounge which also comes with the convenience of a kitchen and dining area. This area of the property comes with UPVC double glazed bay window, laminate flooring, smooth plastered walls and electric heating.

KITCHEN AREA

Well designed kitchen area with modern wall and floor units, matching wooden doors, space for appliances and plenty of worktop space. The walls are part tiled and smooth plastered. The floor is laminated.

BATHROOM

This three piece family bathroom has been completed to a high standard and gives you the ultimate luxury of a bath with shower overhead, wash basin and low level WC. There is a UPVC double glazed window and laminate flooring.

BEDROOM 1

This good sized bedroom should provide plenty of space for your bedroom furniture. It has a double glazed window, laminate flooring, smooth plastered walls and electric wall mounted heater.

OTHER INFORMATION

Council Tax Band B - Portsmouth City Council



Service Charge £1,769 p/a

Ground Rent £200 p/a

Lease - 125 years from January 2002

Current rental income £845.00 pcm.

VIEWING BY APPOINTMENT THROUGH MARINA & HAMPSHIRE LIFE HOMES LTD

All measurements quoted are approximate and are for general guidance only. The fixtures and fittings, services and appliances have not been tested and therefore no guarantee can be given that they are in working order. These particulars are believed to be correct, but their accuracy is not guaranteed and therefore they do not constitute an offer or contract.



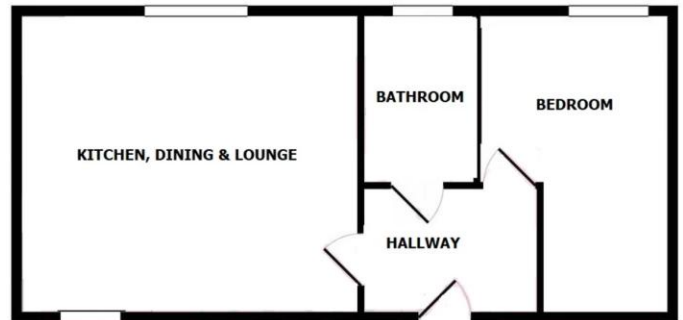

Score	Energy rating	Current	Potential
92+	A		
81-91	B		
69-80	C	78 c	80 c
55-68	D		
39-54	E		
21-38	F		
1-20	G		

11 The Boardwalk, Port
Solent, Portsmouth,
Hampshire, PO6 4TP

www.hampshirlifehomes.co.uk
info@hampshirlifehomes.co.uk
02392 373 446