

Bournside Road

Cheltenham GL51 3AL



Bournside Road, Cheltenham GL51 3AL

This stunning three-bedroom semi-detached home is set within a tree lined road in the wonderful location of Hatherley. The property would make a perfect family home and is ideally located close by to Bournside School and Hatherley Park. The accommodation consists of: - Entrance hall, a living room at the front, at the rear there is a stunning extended kitchen / diner with integrated appliances, an island, dining area and family room. There are two bi-folding doors looking out to the beautifully maintained garden. Upstairs offers of two large double bedrooms, a stylish bathroom with three-piece suite as well as a shower cubicle and lastly a single bedroom. Further benefits include a garage, gas central heating and off-road parking at the front. A must view house in a perfect location.









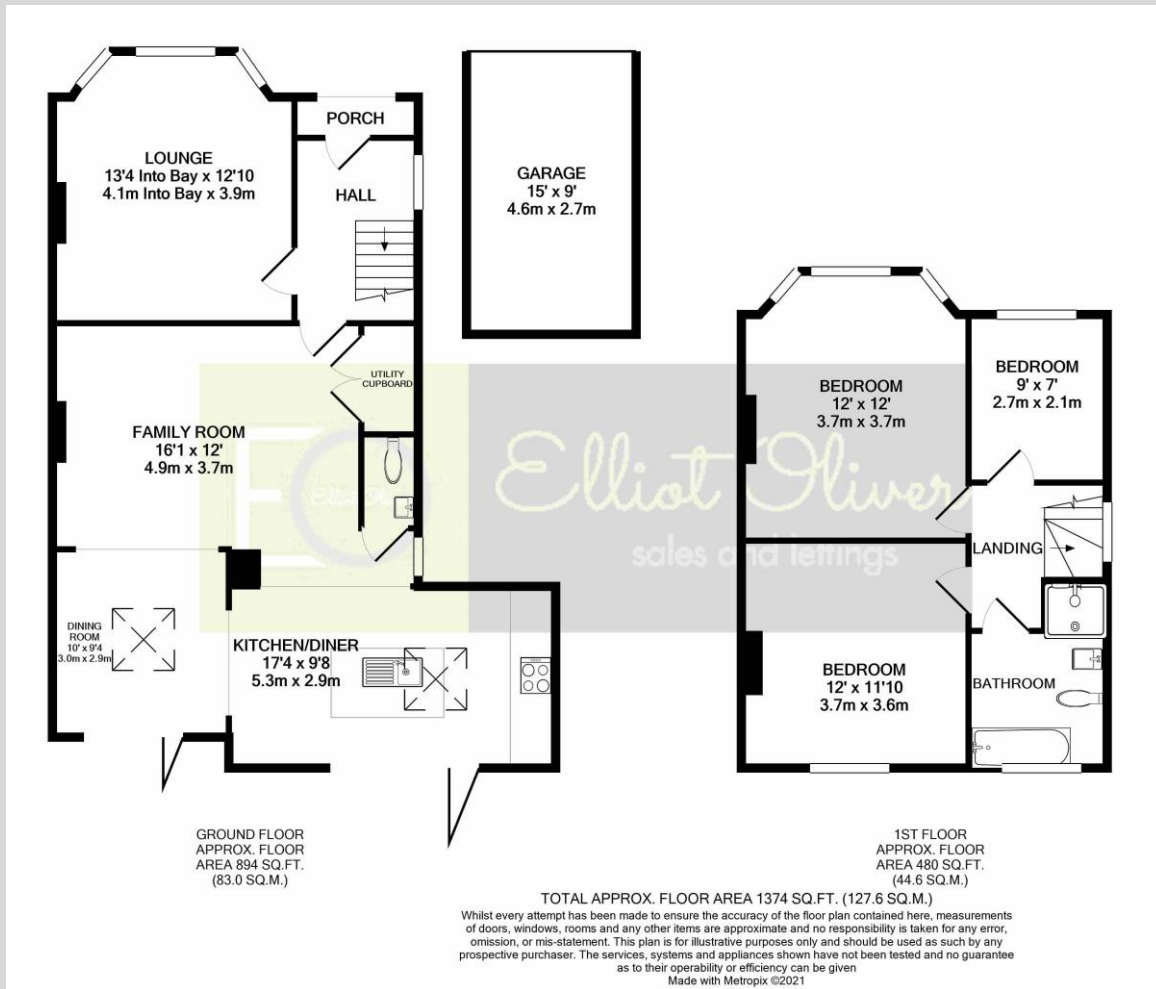

Whilst every attempt has been made to ensure the accuracy of the floor plan contained here, measurements of doors, windows, rooms and any other items are approximate and no responsibility is taken for any error, omission, or mis-statement. This plan is for illustrative purposes only and should be used as such by any prospective purchaser. The services, systems and appliances shown have not been tested and no guarantee as to their operability or efficiency can be given
 Made with Metropix ©2021

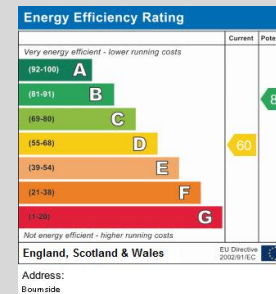

OFFICE
 101 Promenade,
 Cheltenham,
 Gloucestershire, GL50
 1NW
 info@elliottoliver.co.uk

Agents Note: Whilst every care has been taken to prepare these sales particulars, they are for guidance purposes only. All measurements are approximate and for general guidance purposes only and whilst every care has been taken to ensure their accuracy, they should not be relied upon and potential buyers are advised to recheck the measurements