

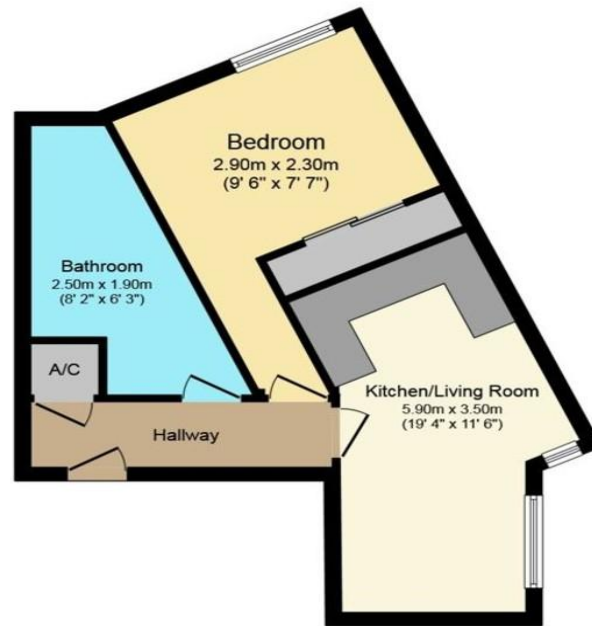

 Double Bedroom Ground Floor Apartment Guide Price Of £97,995  
Shelley Street, Swindon, SN1 3PE

**mcfarlane**  
property.com



### Floor Plan

Floor area 41.3 sq.m. (445 sq.ft.) approx

We  where you LIVE

Our team are friendly, experienced and are all local. They know it better than they do their own living rooms and can help you find what you're looking for because we love where we live.

We would be delighted to show you around this property.

Because every home needs a personal touch.

Total floor area 41.3 sq.m. (445 sq.ft.) approx

This Floor Plan is for illustration purposes only and may not be representative of the property. The position and size of doors, windows and other features are approximate. Unauthorized reproduction prohibited. © PropertyBOX

- Ground Floor Apartment
- Old Town Position
- Communal Sun Terrace with Views
- Lease of 984 Years approx Potential Yield of 6.75%+

An Ideal Investment property or First Time Purchase positioned In Old Town Swindon. This Ground Floor Apartment offers well presented and proportioned accommodation on the Ground Floor the accommodation is well presented with a delightful Living Area with Kitchen and Dining Space. There is a Double Bedroom with fitted double wardrobes, Plus a Family Bathroom. Ideally placed for the Town and Amenities. Local Transport Links are nearby with Mainline Train Station. There is also A Communal Sun Terrace accessed through the building, this has far reaching views across Swindon. No Chain and Vacant Possession. Call Tim Stanley or Thomas Harper. 01793 751 044

**Tim Stanley**  
Sales Manager, Cricklade



☎ 01793 751044

✉ tim@mcfarlaneproperty.com

mcfarlaneproperty.com

**mcfarlane**  
property.com

**Swindon.**  
28-30 Wood Street  
Swindon SN1 4AB  
☎ 01793 611841

**Cricklade.**  
102 High Street  
Cricklade SN6 6AA  
☎ 01793 751044

**Marlborough.**  
106 High Street  
Marlborough SN8 1LT  
☎ 01672 514380

Agents Note: Whilst every care has been taken to prepare these sales particulars, they are for guidance purposes only. All measurements are approximate are for general guidance purposes only and whilst every care has been taken to ensure their accuracy, they should not be relied upon and potential buyers are advised to recheck the measurements