

GIRAFFE360

Whilst every attempt has been made to ensure accuracy, all measurements are approximate, not to scale. This floor plan is for illustrative purposes only.

(1) Excluding balconies and terraces

Approximate total area (1)
749.99 ft²
69.68 m²

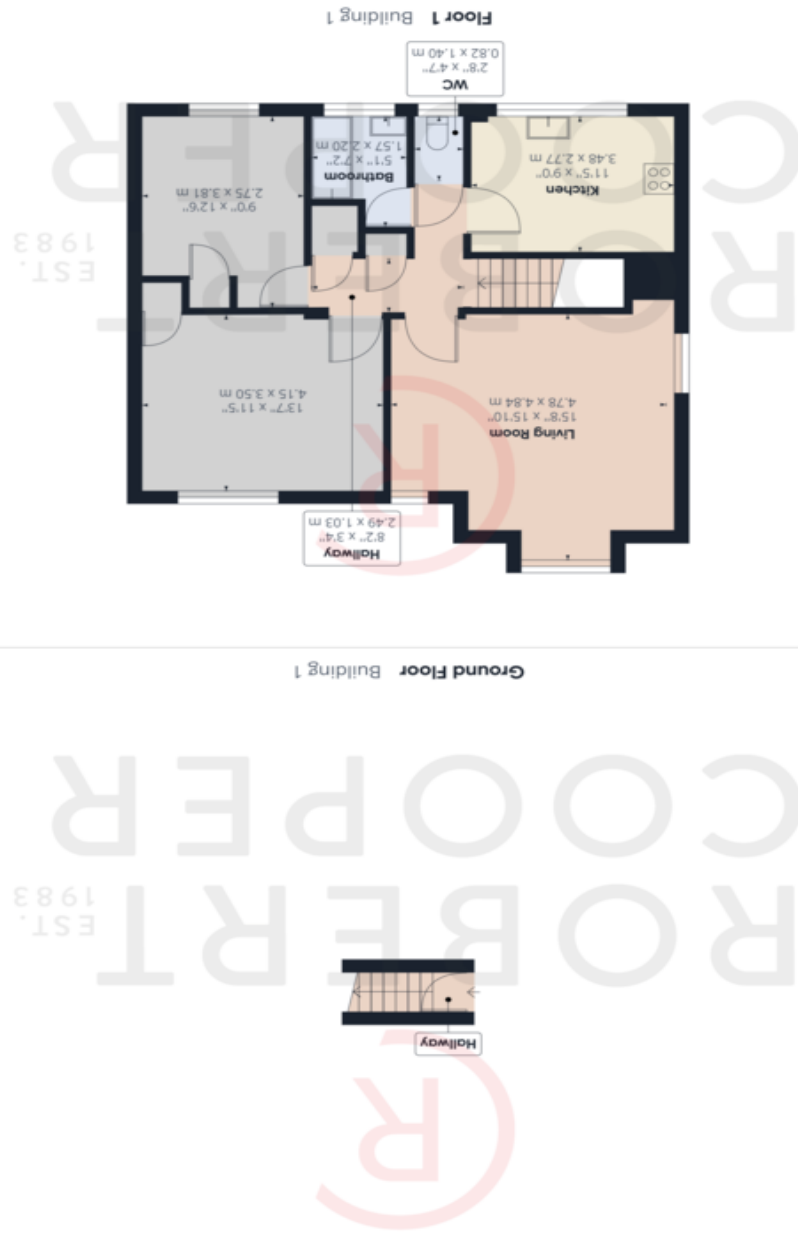

THE SIGERS, HA5 2QJ

£499,950





A beautifully presented two-bedroom first floor maisonette set on this popular residential cul-de-sac set in the heart of Eastcote. Features include no upper chain, private rear garden, garage, modern interiors, separate kitchen and living area, original parquet flooring and two large double bedrooms. The property is 0.4 miles away from Eastcote high street and station (Metropolitan & Piccadilly Line) and 0.7 miles away from the sought after Cannon Lane Primary School.

- Two Double Bedrooms
- Maisonette
- Private Rear Garden
- Garage
- Modern Interiors
- Original Parquet Flooring
- Separate Kitchen & Living Area
- No Upper Chain
- Walking Distance to Met/Piccadilly Line
- Catchment Area for Fantastic Schools

