



Bridewell Street | Clare | CO10 8QD

£895 pcm

A two-bedroom mid terraced cottage in the popular village of Clare is available in November. The property benefits from two bedrooms, a rear garden with views over Clare Country Park and walking distance to local amenities. Call now to secure a viewing.

- Available November
- Two Bedrooms
- Popular Location
- Front and Rear Gardens
- Walking Distance To Amenities
- On Road Parking Available

LIVING ROOM 9' 04" x 12' 23" (2.84m x 4.24m)
Enter from front door into living room. Feature fireplace. Window to front aspect. Stairs to first floor.

KITCHEN/DINER 7' 53" x 11' 79" (3.48m x 5.36m) Range of matching base units with work surface over. Freestanding oven and hob with extractor over. Space and plumbing for fridge/freezer and washing machine. Double sink. Door and window to rear aspect into garden. Door to shower room.

SHOWER ROOM 4' 12" x 7' 53" (1.52m x 3.48m) Shower cubicle, pedestal sink and WC. Window to rear aspect.

BEDROOM ONE 11' 74" x 9' 84" (5.23m x 4.88m) Stairs immediately into bedroom. Window to front aspect.

BEDROOM TWO 10' 21" x 6' 70" (3.58m x 3.61m) Enter into bedroom from bedroom one. Window to rear aspect.

OUTSIDE Laid to stone with a small patio area. Views over Clare Country Park to the rear.

Local Authority – West Suffolk Council
Council Tax Band – A
Post Code – CO10 8QD

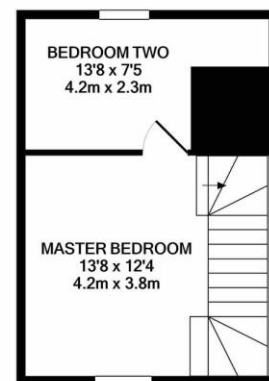
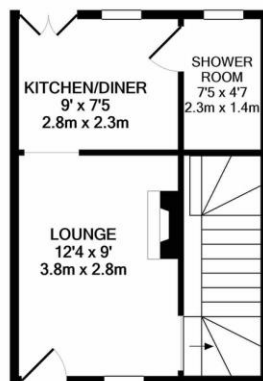

Contact Details

6 King Street, Sudbury, Suffolk, CO10 2EB

Tel: 01787 468400

Email: sudbury@bychoice.co.uk

Score	Energy rating	Current	Potential
92+	A		
81-91	B		86 B
69-80	C		
55-68	D	60 D	
39-54	E		
21-38	F		
1-20	G		

Agents Note: Whilst every care has been taken to prepare these sales particulars, they are for guidance purposes only. All measurements are approximate and for general guidance purposes only and whilst every care has been taken to ensure their accuracy, they should not be relied upon and potential buyers are advised to recheck the measurements

