



Sutton Wharf | Sutton Harbour | Plymouth | PL4 0BL

In Excess Of £120,000

A fourth-floor apartment within Sutton Harbour.

The property is located within a stones throw of the historic Barbican and within the cobbled harbour of the marina.

Upon inspection you will find a large open plan living area with Juliet balcony, a double room with built in wardrobes and bathroom.

The City Centre and The Hoe are within a short walk. This apartment could be of interest to owner occupiers, investment purchasers and holiday homeowners alike. The property is currently let under an Assured Short-hold Tenancy agreement.

- Fourth Floor Apartment
- Sutton Harbour
- Open Plan Living Room
- Upvc Double Glazed Windows
- Fitted Kitchen
- Juliet Balcony
- Marina Location

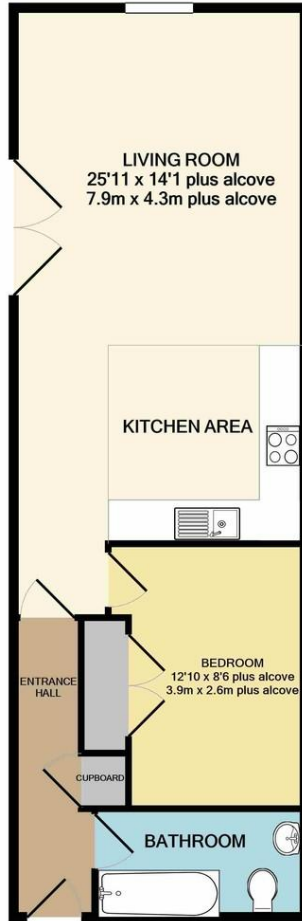

TOTAL APPROX. FLOOR AREA 623 SQ.FT. (57.8 SQ.M.)

Contact Details

48 Ebrington Street
Plymouth
Devon
PL4 9AD

www.athomelettings.com
info@athomeproperty.co.uk
01752 777070

| Energy Efficiency Rating | | |
|--|----------------------------|-----------|
| | Current | Potential |
| <i>Very energy efficient - lower running costs</i> | | |
| (92+) | A | |
| (81-91) | B | 86 |
| (69-80) | C | 76 |
| (55-68) | D | |
| (39-54) | E | |
| (21-38) | F | |
| (1-20) | G | |
| <i>Not energy efficient - higher running costs</i> | | |
| England & Wales | EU Directive 2002/91/EC | |

WWW.EPC4U.COM

Agents Note: Whilst every care has been taken to prepare these sales particulars, they are for guidance purposes only. All measurements are approximate are for general guidance purposes only and whilst every care has been taken to ensure their accuracy, they should not be relied upon and potential buyers are advised to recheck the measurements